

# HS Type Carburettor

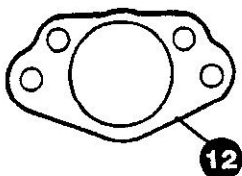
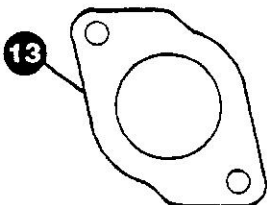
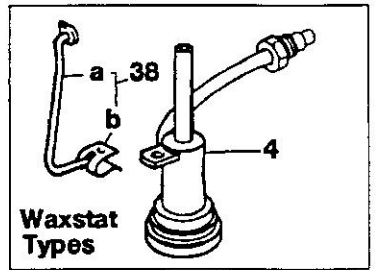
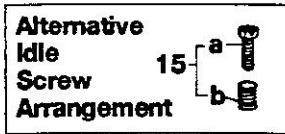
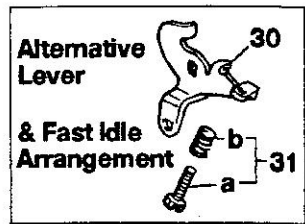
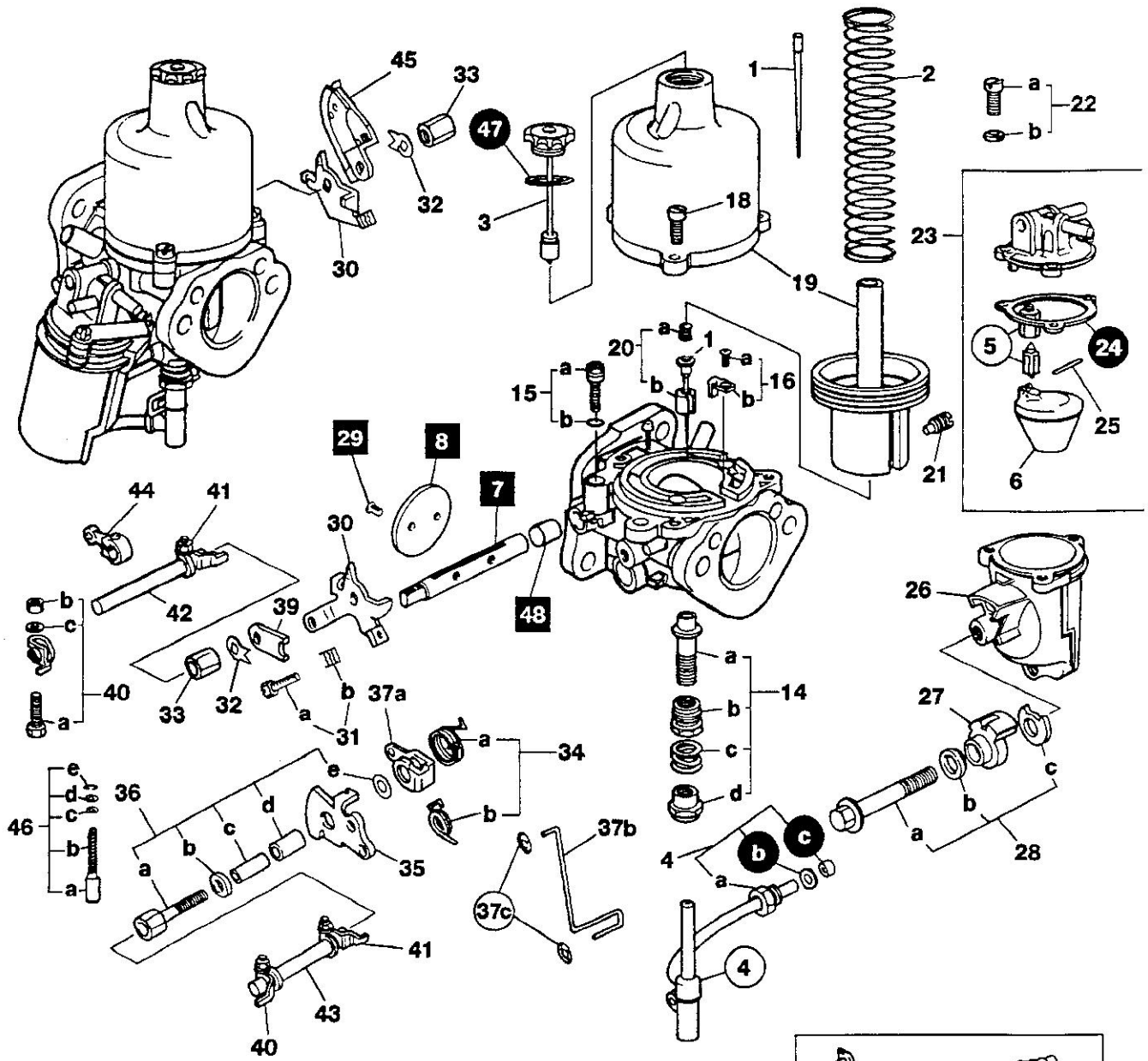

- Gasket Pack
  - Service Kit (CSK) in addition to Gasket Pack
  - Rebuild Kit (CRK) in addition to CSK
- Each kit contains enough components to service one carburettor. The carburettors illustrated are an HS4 pair but most HS types are similar.

# HS Type Carburetter

1	Needle	see spec pages
2	Piston Spring	see spec pages
3	Damper	see spec pages
<b>4</b>	<b>Jet Assembly</b>	see spec pages
a	Nut (HS2, HS4 and HS6 only)	AUD 2129
b	Washer (HS2, HS4 and HS6 only)	AUD 2193
c	Seal (HS2, HS4 and HS6 only)	AUD 2194
<b>5</b>	<b>Needle and Seat Kit</b>	see spec pages
	includes item 24	
<b>6</b>	<b>Float Kit</b>	see spec pages
	includes item 24	
<b>7</b>	<b>Throttle Spindle Kit</b>	see spec pages
	includes items 12,13,29 & 32	
<b>8</b>	<b>Throttle Disc Kit</b>	see spec pages
	includes items 12,13 & 29	
<b>9</b>	<b>Gasket Pack</b>	see spec pages
	includes items marked ●	
<b>10</b>	<b>Service Kit</b>	see spec pages
	includes items marked ● & ○	
<b>11</b>	<b>Rebuild Kit</b>	see spec pages
	includes items marked ●, ○ & ■	
12	Gasket - Air Inlet	see page 166
13	Gasket - Engine Flange	see page 166
<b>14</b>	<b>Jet Bearing Kit</b>	see page 163
a	Jet Bearing	see page 163
b	Jet Lock Nut	AUC 2002
c	Spring	AUC 2114
d	Jet Adjusting Nut	various
<b>15</b>	<b>Idle Adjusting Screw Kit</b>	various
a	Idle Adjusting Screw	see page 168
b	Idle Adjusting Screw Seal or Spring*	various
<b>16</b>	<b>Piston Guide Key Kit</b>	<b>WZX 1120</b>
a	Screw	AUC 2099
b	Guide Key	AUC 2054
17	Circlip	—
18	Suction Chamber Screws (see 22)	JZX 1394
19	Suction Chamber Assembly	various
<b>20</b>	<b>Needle Guide Kit</b>	see page 148
a	Needle Spring	see page 148
b	Needle Guide	see page 148
21	Needle Lock Screw	various
<b>22</b>	<b>Float Lid Screw Kit</b>	<b>WZX 1287</b>
a	Float Lid Screw	JZX 1394
b	Washer	AUC 2246
<b>23</b>	<b>Float Lid Assembly</b>	see page 153
24	Float Lid Gasket	AUC 8459
25	Float Spindle	AUC 1152
26	Float Chamber	see page 168
27	Float Chamber Adaptor	see page 167
<b>28</b>	<b>Float Chamber Mounting Kit</b>	various
a	Bolt	various
b	Spring Washer	various
c	Washer	various

29	Throttle Disc Screw	AUC 1358
30	Throttle Lever	various
<b>31</b>	<b>Fast-Idle Screw Kit</b>	various
a	Adjusting Screw	see page 168
b	Screw Clip or Spring*	various
32	Tab Washer	AUC 1206
33	Throttle Spindle Nut	AUC 1424
<b>34</b>	<b>Choke Return Spring Kit</b>	see page 163
a	Choke Spring	see page 163
b	Lost Motion Spring	see page 163
35	Choke Cam Lever	various
<b>36</b>	<b>Pivot Bolt Kit</b>	various
a	Pivot Bolt (as illustration only)	AUC 1426
b	Washer (as illustration only)	AUC 2429
c	Inner Tube (as illustration only)	AUC 8473
d	Outer Tube (as illustration only)	AUC 2430
e	Washer (as illustration only)	AUC 2433
<b>37</b>	<b>Pick Up Lever and Link Kit</b>	see page 163
a	Pick Up Lever	see page 163
b	Pick Up Link	see page 163
c	Link Clip	AUC 5002
37a	Pick-Up Lever (waxstat jet)	various
<b>38</b>	<b>Link Kit (waxstat jet)</b>	see page 163
a	Link (waxstat jet)	see page 163
b	Clip (waxstat jet)	JZX 1259
39	Lost Motion Lever	AUC 1400
40	Interconnection Lever (right hand)	AUE 587
41	Interconnection Lever (left hand)	AUE 586
42	Interconnection Rod Throttle	see page 165
43	Interconnection Rod Choke	see page 165
44	Throttle Cable Lever	various
45	Throttle Cable Lever (alternative)	various
<b>46</b>	<b>Piston Lift Pin Kit (where fitted)</b>	various
a	Piston Lift Pin (as illustration only)	AUC 2065
b	Spring (as illustration only)	AUC 2066
c	Washer (as illustration only)	AUC 4943
d	Washer (as illustration only)	AUC 4944
e	Circlip (as illustration only)	AUC 4150
47	Damper Washer (where fitted)	AUC 4900
48	Throttle Spindle Bush	(see note a below)

\*Early carbs had screws and spring - see inset on facing page  
a. HS4, HS6, HS8 = AUD 3080. HS2 = AUD 3079

**Note:** Refer to page 6 for help identifying the carburetter's specification. This is particularly important when ordering spares for HS types. Refer to page 8 for details of carburetter sundries kits.