

**Engine Model  
CPL**

# 6BTA 5.9

(CDC 6.590)

**TURBOCHARGED  
AFTERCOOLED**

**NON - EMISSION  
359 Cubic Inch**

Piston Std (m): 7156

## CUMMINS CPL's

599	792	983	1523
600	834	998	1524
698	912	1174	1581
712	940	1209	2050
715	961	1518	2530
742 *	962	1519	2891

\* Marine Engine

## CASE-IH (Agricultural)

1640	Combine,
	(PIN: JJC0034705 >)
1644	Combine,
	(ESN 44937696 >)
1822	Cotton Picker,
	(PIN: JJC0012691 >)
2022	Cotton Picker
2096	Tractor

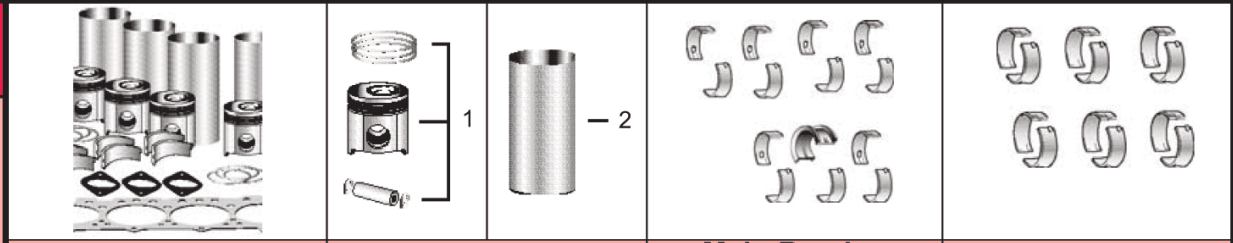

Eng. O/H & I/F Kit	1) Piston Kit *	Main Bearing Set	Con Rod Bearing
<b>COK2100/6</b> Std.	<b>2) Repair Sleeve</b>	<b>Use 1</b> <a href="#">C3802070</a> Std. <a href="#">C3802071</a> 0.25 mm <a href="#">C3802072</a> 0.50 mm <a href="#">C3802073</a> 0.75 mm	<a href="#">C3901170</a> Std. <a href="#">C3901171</a> 0.25 mm <a href="#">C3901172</a> 0.50 mm <a href="#">C3901173</a> 0.75 mm <hr/> <a href="#">C4893693</a> Std. ● <a href="#">C4892795</a> 0.25 mm ● <a href="#">C4892796</a> 0.50 mm ● <a href="#">C4892797</a> 0.75 mm ●
<b>COK2102/6</b> 0.50 mm	1) <a href="#">C3802100</a> Std.		
<b>COK2104/6</b> 1.00 mm	<a href="#">C3802102</a> 0.50 mm <a href="#">C3802104</a> 1.00 mm		
<b>COK2100F/6</b> Std. ●	<b>Use 6</b>		
<b>COK2102F/6</b> 0.50 mm ●			
<b>COK2104F/6</b> 1.00 mm ●	2) <a href="#">C3904166</a>		
<b>To order an In-Frame Kit change OK to IK</b>			

\* Piston Kit consists of:  
 1) 1 [C3907156](#) Piston Std, 1 [C3802230](#) Ring Set Std, 1 [C3901793](#) Piston Pin, 2 [C3901706](#) Ret.  
 2) 1 [C3907157](#) Piston 0.50 mm, 1 [C3802232](#) Ring Set 0.50 mm, 1 [C3901793](#) Piston Pin, 2 [C3901706](#) Ret.  
 3) 1 [C3907158](#) Piston 1.00 mm, 1 [C3802234](#) Ring Set 1.00 mm, 1 [C3901793](#) Piston Pin, 2 [C3901706](#) Ret.

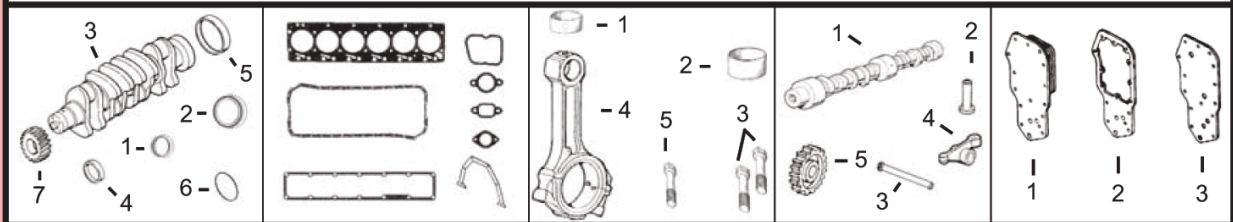

1) Front Seal 2) Rear Seal	1) Top Gasket Set 2) Bottom Gasket Set	1) Bushing, Piston 2) Bushing, Cam	1) Camshaft 2) Tappet 3) Push Rod 4) Rocker Arms 5) Camshaft Gear	1) Oil Cooler 7 Plate 2) Oil Cooler Gasket 3) Oil Cooler Gasket Filter Head
3) Crankshaft 4) Front Seal Sleeve 5) Rear Seal Sleeve 6) Rectangular Seal 7) Crankshaft, Gear	3) Head Gasket 4) Oil Pan Gasket 5) Valve Cover Gsk 6) Gear Housing Gsk 7) Rear Cover Gsk	3) Bolt, Con Rod 4) Con Rod 5) Bolt, Ex Manifold		
1) <a href="#">C3904353</a> 2) <a href="#">C3353978</a> 3) <a href="#">C3907804</a> 4) <a href="#">C3906080</a> 5) <a href="#">C3906081</a> 6) <a href="#">C3912473</a> 7) <a href="#">C3901258</a>	1) <a href="#">C3802363</a> 2) <a href="#">C3802376</a> 3) <a href="#">C3921394</a> 4) <a href="#">C3931346</a> (7) 5) <a href="#">C3902666</a> 6) <a href="#">C3916131</a> 7) <a href="#">C3928493</a>	1) <a href="#">C4891178</a> x6 2) <a href="#">C3901306</a> x1 (3) 3) <a href="#">C3900919</a> x12 4) <a href="#">C3901569</a> (8) <a href="#">C4943979</a> (8) 5) <a href="#">C3944593</a>	1) <a href="#">C3914639</a> 2) <a href="#">C3925031</a> 3) <a href="#">C3904679</a> 4) <a href="#">C3910811</a> x6 <a href="#">C3910810</a> x6 5) <a href="#">C3907431</a>	1) <a href="#">C3921558</a> 2) <a href="#">C3926760</a> 3) <a href="#">C3929792</a>

Guide, Valve	1) Intake, Valve Kit 2) Insert, Valve	1) Exhaust, Valve Kit 2) Insert, Valve	1) Spring, Valve 2) Seal, Valve 3) Retainer, Valve
	<a href="#">C3904408</a> <b>Thick W. 60.50 mm IN</b> <a href="#">C3904409</a> <b>Thick W. 51.75 mm EX</b> <a href="#">C3906206</a> (1) <b>Thin Wall</b>	1) <a href="#">C3802355</a> Kit Consists of: <a href="#">C3901117</a> Valve x1 <a href="#">C3900250</a> Collet x2 2) <a href="#">C3906854</a> <b>Use 6</b>	1) <a href="#">C3802356</a> Kit Consists of: <a href="#">C3901607</a> Valve x1 <a href="#">C3900250</a> Collet x2 2) <a href="#">C3904105</a> <b>Use 6</b>
	1) <a href="#">C3900276</a> x12 2) <a href="#">C3921640</a> x12 (5) <a href="#">C3957912</a> x12 (6) 3) <a href="#">C3900299</a> x12 (5)		

			(●) On Fracture Split Con Rods use: 6 of <a href="#">C3901170</a> (or O/S) and 6 of <a href="#">C4893693</a> (or O/S). (1) Can be Used on Both Intake and Exhaust. (2) Diaphragm Style. (3) For Storm blocks use <a href="#">C3940059</a> . (4) Do not use on Marine Engines. (5) For use on engines prior to April, 2003. (6) For use on engines from April, 2003, (Top Hat Style). (7) Applications with internally cast oil suction tube in Aluminum oil pan, must use 3938161 oil pan gasket. (8) C3901569 Machine Split rod. C4943979 Fracture Split rod.
1) Water Pump 2) Water Pump Seal 3) Thermostat	1) Pump, Oil 2a) Lift Pump 2b) Lift Pump	1) Cylinder Head (With Valves) 2) Head Bolts	
1) <a href="#">C3286277</a> 2) <a href="#">C3906698</a> 3) <a href="#">C3802273</a>	1) <a href="#">C3926203</a> 2a) <a href="#">C3918000</a> 2b) <a href="#">C3904374</a> (2)	1) <a href="#">C3913381</a> (4) 2) <a href="#">C3920779</a> x6 <a href="#">C3920780</a> x14	