

**Engine Model
CPL**

6CTA 8.3

(CDC 6.830)

**TURBOCHARGED
AFTERCOOLED**

Piston Std (m):
3164, 9565, 9930

CUMMINS CPL's

604	1212	1547	2380
754	1222	1612	9803
755	1270	1633	9883
830	1273	1804	
893	1321	1826	
959	1377	1903	
984	1539	2054	

CASE-IH (Agricultural)

1670 Combine, ESN 44706126 >
1680 Combine, ESN 44706126 >
1688 Combine
1844 Cot Picker, PIN JJ002462 >
2044 Cot Picker, ESN 44706126 >
2055 Cot Picker
2155 Cot Picker, PIN > JJC0156230
2188 Combine, PIN > JJC0191483
7140 Tractor, ESN 44706126 >
7150 Tractor, ESN 44706126 >
9230 Tractor, ESN 44706126 >
9240 Tractor, ESN 44706126 >
9330 Tractor

CASE (Construction)

6830TA Power Unit

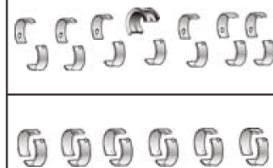
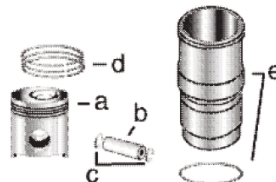

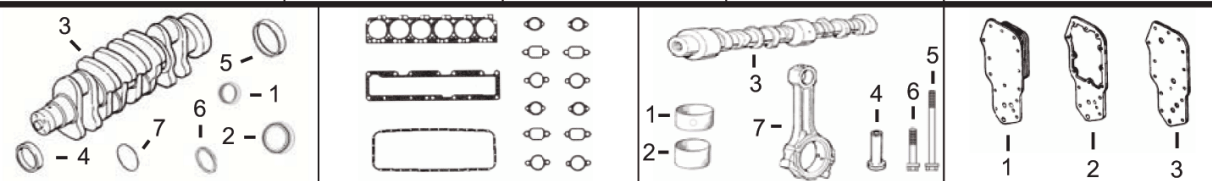

Engine Overhaul & Engine In Frame Kit	Cylinder Kit Thin Wall (*)	Cylinder Kit Thick Wall (**)	Cylinder Kit Thick Wall (***)	Main Bearing Set
COK2401 Thin Wall	C3802401	C3802404	C3802404S	Con Rod Bearing
COK2404 Thick Wall Long	Consists of:	Consists of:	Consists of:	Use 1
COK2404S Thick Wall Short	a) C3923164 b) C3901597 c) C3901996 d) C3802258 e) C3802370	a) C3923164 b) C3901597 c) C3901996 d) C3802258 e) C3802407	a) C3923164 b) C3901597 c) C3901996 d) C3802258 e) C3800328	C3802210 Std. C3802211 0.25 mm C3802212 0.50 mm C3802213 0.75 mm
To order an In-Frame Kit change OK to IK in above part number	(C3907792 Liner + C3907177 Seal)	(C3919937 Liner + C3907177 Seal)	(C3948095 Liner + C3907177 Seal)	Use 12 (1)

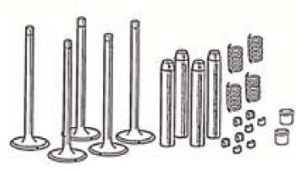

1) Front Seal 2) Rear Seal	1) Top Gasket Set 2) Bottom Gasket Set	1) Bushing, Piston 2) Bushing, Camshaft	1) Oil Cooler 12 Plate 2) Oil Cooler Gasket 3) Oil Cooler Gasket Filter Head
3) Crankshaft 4) Front Wear Sleeve 5) Rear Wear Sleeve 6) Front Rectangular Seal 7) Rear Rectangular Seal	3) Head Gasket 4) Oil Pan Gasket 5) Valve Cover Gasket 6) Front Gear Gasket 7) Front Cover Gasket 8) Rear Cover Gasket	3) Camshaft 4) Tappet 5) Head Bolt Long 6) Head Bolt Short 7) Con Rod	
1) C3353977 2) C3353978 3) C3918986 4) C3908277 5) C3906081 6) C3903475 7) C3912473	1) C4025271 2) C3800348 3) C3938267 4) C3914017 5) C3905449 6) C3929253 7) C3917780 8) C3914301	1) C3913990 x6 2) C3943199 x7 3) C3924471 (2) 4) C3925031 5) C3917728 x14 (3) 6) C3917729 x12 (3) 7) C3901383 (4)	1) C3918175 2) C3918174 3) C3914308

	1) Intake, Valve Kit 2) Insert, Valve	1) Exhaust, Valve Kit 2) Insert, Valve	1) Spring, Valve 2) Seal, Valve 3) Guide, Valve 4) Retainer, Valve Spring
	1) C3802463 Consists of: C3924492 Valve x1 C3901177 Collet x2 2) C3924582 Use 6	1) C3802085 Consists of: C3921444 Valve x1 C3901177 Collet x2 2) C3924583 Use 6	1) C3906412 x12 2) C3915707 x12 3) C3923564 x12 4) C3912976 x12

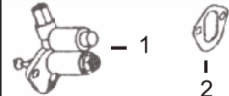
		
1) Water Pump 2) Water Pump Seal 3) Thermostat	Oil Pump	1) Fuel Lift Pump 2) Fuel Pump Gsk
1) C3800976 (5) (6) 2) C3902089 3) C3928639 x2	C3930338 (3415365)	1) C3917998 2) C3914304

- (*) Block 3802265 (Thin Wall) Flange ø 5.223".
- (**) Block 3802408 (Thick Wall / Long Liner) Flange ø 5.152", (Length: 9.33" / 237 mm).
- (***) Block 3934906 (Thick Wall / Short Liner) Flange ø 5.152", (Length: 9.12" / 234 mm).
- (1) Order in multiples of two.
- (2) To use [C3924471](#) to replace 3917882 buy the following from Cummins: 3918777 Cam Gear, 3927155 Thrust and 3902332 Key.
- (3) Only use on engines built from year 1991 onwards.
- (4) Do not use with Crankshaft part number 3965006.
- (5) Some applications use short nose pump [C3806180](#).
- (6) Marine applications use [C3800975](#).