

300 Series
Engine & Equipment
Model

4.239T

4 Cyl

Bore: 4.19 in
 106.5 mm

Pin Ø: 1.625 in
 41 mm

Con Rod (m):
 R80032, R113612,
 R122191

APPLICATIONS:

AGRICULTURAL

- 945 2750
- 952 2755
- 1052 2755 CS/TSS
- 1155 2850
- 2140 2855
- 2450 2855N
- 2555 3430
- 2555 TSS 3830
- 2650

CONSTRUCTION

- 310 C/D (Turbo)
- 315 C/D (Turbo)
- 515B

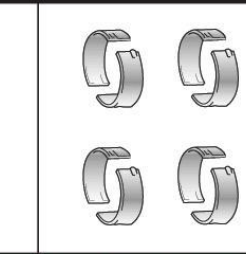
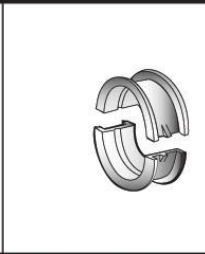
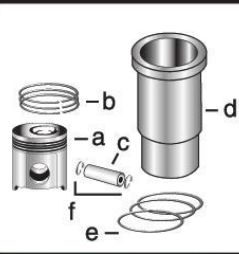

1) Engine O/H Kit	Piston-Liner Kit	Main Bearing	Thrust Bearing	Con Rod Bearing
2) Engine I/F Kit	TRE33115 Consists of:	TRE27352 Std.	TAT21139 Std.	TRE27348 Std.
1) TRE54709	a) TRE19278	TRE27353 .010	TAT21132 .010	TRE27349 .010
2) TIK54709	b) TRE66820	TRE27360 .020	TAT21134 .020	TRE27358 .020
	c) TR124230	TRE27368 .030	TAT21136 .030	TRE27364 .030
	d) TR116281			
	e) TAR65507			
	f) TR54114	Use 4	Use 1	Use 4

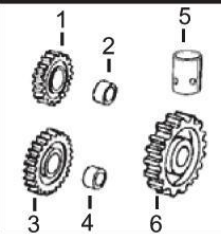
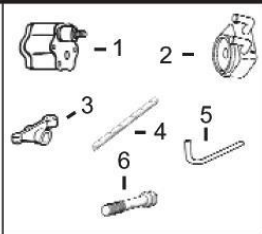
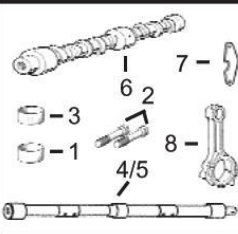
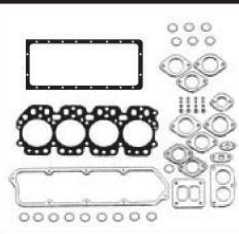
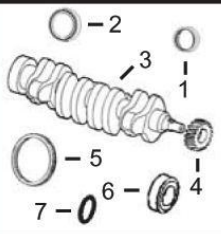

1) Front Seal 2) Rear Seal	1) O/H Gasket Set	1) Bush, Con Rod 2) Bolt, Con Rod 3) Bush, Bal. Shaft	1) Pump, Oil 2) Oil Cooler 3) Rocker Arm 4) Rocker Shaft 5) Pump, Oil Tube 6) Cyl Hd Cap Screw	1) Lower Gear 2) Lower Bushing 3) Upper Gear 4) Upper Bushing 5) Cam. Follower 6) Cam. Gear
3) Crankshaft 4) Crankshaft, Gear 5) Ring Gear 6) Sleeve, Front 7) Packing, Sleeve	2) Head Gasket Set 3) Head Gasket 4) Oil Pan Gasket 5) Rocker Cover Gsk	4) Bal. Shaft R/H 5) Bal. Shaft L/H 6) Camshaft 7) Bal. Shaft Stop 8) Con Rod		
1) TAR67942 2) TRE44574 3) TAT18030 (1) or TRE20585 (4) 4) TT20094 5) TR114282 (142T) 6) TR81989 7) TH35244	1) TRE501579 2) TRE38851 3) TR125863 4) TR97342 5) TR73521	1) TR57451 x4 2) TR80033 x8 3) TR57160 x6 (3) 4) TRE26282 R/H (*) 5) TRE26283 L/H (*) 6) TR82820 (5) 7) TR88112 8) TRE58347	1) TRE55343 (2) 2) TRE31929 3) TRE31973 4) TR54987 5) TR113752 6) TR85363 x18 (6)	1) TAT24252 2) TT26321 3) TAT18009 4) TT20034 5) TT20073 6) TT20070



Valve, Intake	Valve, Exhaust	Insert, Valve 1) Intake 2) Exhaust	1) Cap, Valve 2) Lock, Valve	1) Spring, Valve 2) Rotator, Valve 3) O'ring, Valve
TR83071 Std. TR89223 .003 TR89224 .015	TR79624 Std. TR79625 .003 TR79626 .015	1) TR73064 Std. 2) TR51734 Std.	1) TT20129 2) TT20077	1) TR26125 2) TRE11410 3) TR87627

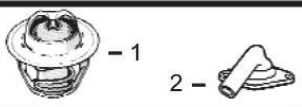

1) Thermostat 2) Thermostat Cover	Fuel Transfer Pump	Water Pump Rep Kit a) Without Impeller b) With Impeller	Water Pump	Transmission Oil Pump	1) Seal 2) Injector, Pencil
1) TAR48675 180° F 2) TT23620	TRE42211	See Chart	TAR97708 (m) R73604	TAL120106 TAL68094	1) TR60746 TR48000 2) TRE37503
				Verify P/N for your application	

(*) If these engines use bolt on weights shafts use **TAR69710** RH and **TAR69711** LH.

(1) **TAT18030** Crankshaft 36mm (short) snout, (m) T23517.

(2) May use High Capacity Pump, Oil **TRE65580**.

(3) **TR91708** (Outer Diam. 2.00 mm / 0.078 in) Larger and **TR57160R** (Inner Diam 0.5 mm / 0.020 in) Smaller, are also available.

(4) **TRE20585** Crankshaft 60mm (long) snout, (m) R81959 or R121018.

(5) Threaded Type.

(6) Replace all R78558 Cap Screws with Flanged Head Cap Screw **TR85363**.