

**PowerTech**

**Engine & Equipment  
Model**

**6081**

**High Comp. Piston**

4801 4803

**8.1L**

Bore: 4.56 in  
116 mm  
Pin Ø: 1.85 in  
47 mm

**Con Rod (m):**

R116340 (ESN > 86,536)  
R501034 (ESN 86,537 >)

**APPLICATIONS:**

**See Index**

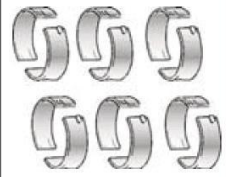
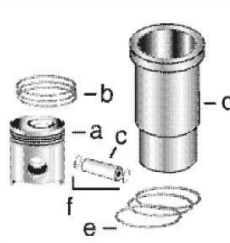

<b>1) Engine O/H Kit</b>	<b>Piston-Liner Kit</b>	<b>Main Bearing</b>	<b>Thrust Bearing</b>	<b>Con Rod Bearing</b>
<b>2) Engine I/F Kit</b>	<b>TRE64509</b> Consists of:	<b>TRE504195 Std.</b> <b>TRE504196 .011</b>	<b>TRE504198 Std.</b> <b>TRE504199 .011</b>	<b>TR116081 Std.</b> <b>TRE57167 .011</b>
<b>1) TOK504201</b>	a) <b>TRE70688</b>	<b>Use 6</b>	<b>Use 1</b>	<b>Use 6</b>
<b>2) TIK504201</b>	b) <b>TRE503528</b> c) <b>TR57771</b> d) <b>TR116236</b> e) <b>TAR98850</b> f) <b>TE1343FN</b>			
			<b>Thrust Washer</b> <b>TRE61253 Std.</b>	
			<b>Use 3, Order Qty 1</b>	

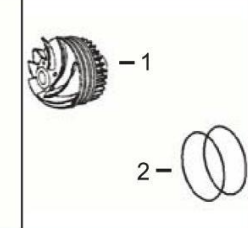
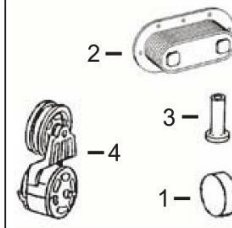
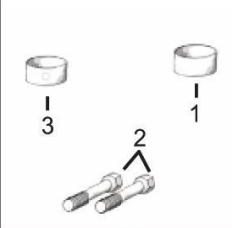
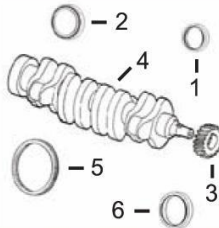

<b>1) Front Seal</b> <b>2) Rear Seal</b>	<b>1) O/H Gasket Set</b>	<b>1) Bush, Con Rod</b> <b>2) Bolt, Con Rod</b> <b>3) Bushing, Cam</b>	<b>1) Plug Camshaft</b> <b>2) Oil Cooler</b> <b>3) Tappet</b> <b>4) Tensioner, Belt</b>	<b>1) Pump, Water</b> <b>2) O'ring Mount Kit</b>
<b>3) Crankshaft Gear</b> <b>4) Crankshaft</b> <b>5) Ring Gear</b> <b>6) Rear Gear</b>	<b>2) Head Gasket Set</b> <b>3) Head Gasket</b> <b>4) Oil Pan Gasket</b>			
<b>1) TAR49025</b> <b>2) TRE520036</b> <b>3) TR104587</b> <b>4) TRE535300 (1)</b> or <b>TRE534314 (2)</b> <b>5) TR28811</b> <b>6) TR63326</b>	<b>1) TRE506220</b> <b>2) TRE506222</b> <b>3) TRE55475</b> <b>4) TR71918 (3)</b>	<b>1) TR74008 x6</b> <b>2) TR66452 x12 (4)</b> <b>3) TR87561 x4</b>	<b>1) TR82007</b> <b>2) TAR55394</b> <b>3) TR110126</b> <b>4) TRE518097 (9)</b> <b>TRE68715 (9)</b> <b>TRE57498 (9)</b>	<b>1) TRE521502</b> <b>2) TRE509463</b>



Valve, Intake	Valve, Exhaust	Insert, Valve 1) Intake 2) Exhaust	1) Cap, Valve 2) Lock, Valve 3) Shield, Valve	1) Spring, Valve
<b>TR84618 Std.</b> <b>TR93308 .003</b> <b>TR93312 .015</b>	<b>TR84619 Std.</b> <b>TR93311 .003</b> <b>TR93313 .015</b>	<b>1) TR121193</b> <b>2) TR119132</b>	<b>1) TT20129</b> <b>2) TT20077</b> <b>3) TR102882 x6 (5)</b> <b>TR501640 x6 (6)</b>	<b>1) TR91822 (7)</b> <b>TR502187 (8)</b>



<b>Thermostat</b>	<b>Pump, Oil</b>	<p>(1) With helical oil pump drive gear. Do not use with HPCR fuel system.</p> <p>(2) With straight oil pump drive gear.</p> <p>(3) With Aluminum Oil Pan use <a href="#">TR49377</a> (RE504822).</p> <p>(4) Use <a href="#">TR66452</a> Rod Bolts with Machine Split Connecting Rods, and use <a href="#">TR501035</a> Rod Bolts with Fractured Split Connecting Rods.</p> <p>(5) For engine ESN 199,999 and below. For Exhaust Valves only.</p> <p>(6) For engine ESN 200,000 and above. For Exhaust Valves only.</p> <p>(7) For engine ESN 199,999 and below.</p> <p>(8) For engine ESN 200,000 and above.</p> <p>(9) Check application for proper usage.</p>		
<b>TAR48675 180° F</b>	<b>TRE60622</b>			