

400 Series

Engine & Equipment
Model

6.404T/A

> 335,845

6 Cyl

Bore: 4.25 in
108 mm
Pin Ø: 1.61 in
41 mm

Block (m):

R43310, R45980, R47020
R47110

APPLICATIONS:

AGRICULTURAL

4320
4520
4620
5440

CONSTRUCTION

644
644A
646
646B
690
690A

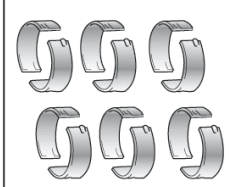
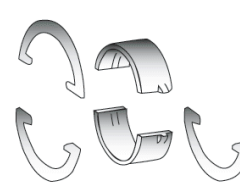
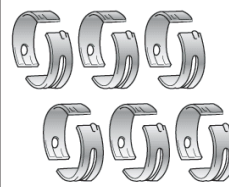
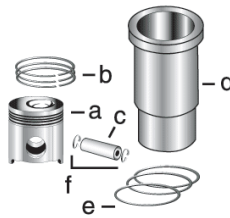
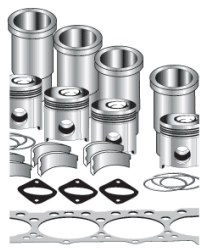

1) Engine O/H Kit	Piston-Liner Kit	Main Bearing	Thrust Bearing	Con Rod Bearing
-------------------	------------------	--------------	----------------	-----------------

2) Engine I/F Kit	TAR51798 Consists of: a) TAR50624 b) TAR51741 c) TR41425 d) TR40615 e) TAR65507 f) TR54114	TAR74814 Std. TAR74816 .010 TAR74817 .020 TAR74818 .030 Use 6	TAR77748 Std. TAR77750 .010 TAR77751 .020 TAR77752 .030 Use 1 Thrust Washer TAR77747 Std. TAR77753 .007 Use 3, Order Qty 1	TAR45723 Std. TAR46396 .010 TAR46397 .020 TAR46398 .030 Use 6
1) TRG21340				
2) TIK21340				

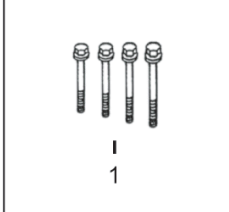
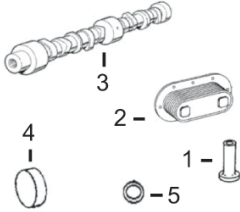
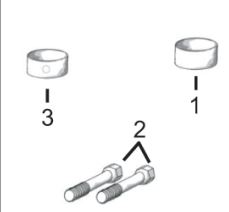
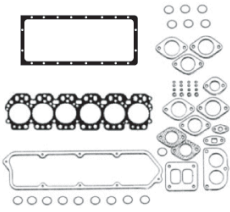
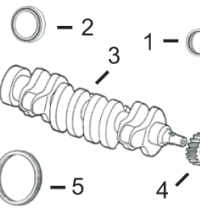

1) Front Seal 2) Rear Seal	1) O/H Gasket Set	1) Bush, Con Rod 2) Bolt, Con Rod 3) Bushing, Cam	1) Cam Follower 2) Oil Cooler 3) Camshaft Kit 4) Plug, Camshaft 5) O'ring, Oil Cooler	1) Head Bolt Kit
3) Crankshaft 4) Crankshaft, Gear 5) Ring Gear	2) Head Gasket Set 3) Head Gasket 4) Oil Pan Gasket			

1) TAR49025 2) TRE520036 3) TRE53422 (3) 4) TR26049 (23T) 5) TR28811 (129T)	1) TAR53094 2) TAR63270 3) TR48291 4) TR71918	1) TR42173 x6 2) TR66452 x12 3) TR46903 x4	1) TR52773 2) TAR55394 For T Engines TAT25038 For A Engines 3) TAR100385 4) TR26115 5) TR47153	1) TMX365 (1)
---	--	--	---	-------------------------------

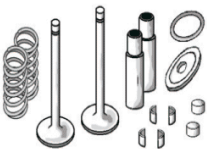

Valve, Intake	Valve, Exhaust	Insert, Valve 1) Intake 2) Exhaust	1) Cap, Valve 2) Lock, Valve	1) Spring, Valve 2) Rotator, Valve 3) O'ring, Valve
TR43883 Std. (2) TR45003 .003 TR45004 .015	TR43679 Std. TR43787 .003 TR43788 .015	1) TR43680 Std. 2) TR43681 Std.	1) TT20129 2) TT20077	1) TR26125 2) TRE11410 3) TR87627

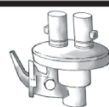

Thermostat	Fuel Transfer Pump	Water Pump Repair Kit		Pump, Oil, Quad Transmission
TR36846 180 °F	TAR49771	Without Impeller	With Impeller	TRE20918 For Tractors 4320, 4520, 4620
		See Chart		

(1) [TMX365](#) Consists of: [TR88042](#) x6, [TR88043](#) x5, [TR88044](#) x8, [TR88045](#) x7.
 (2) Use [TR43914](#) Std (30° Angle) on ESN > 245,547-335,845.
 (3) [TRE53422](#) will require front key [TR116311](#) for the front damper.