

400 Series
Engine & Equipment
Model

6.466D

6 Cyl

Bore: 4.56 in
 116 mm
 Pin Ø: 1.61 in
 41 mm

Con Rod (m):
 R66922, R58882, R41423

APPLICATIONS:

AGRICULTURAL

4050
 4240
 6620

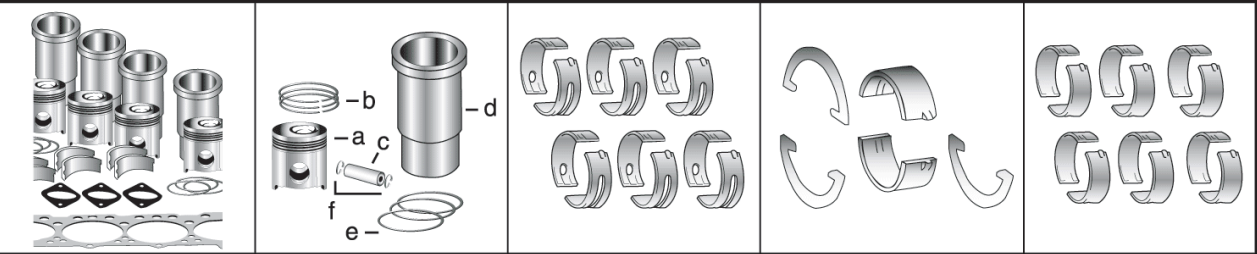

| | | | | |
|--------------------------|---|--|---|--|
| 1) Engine O/H Kit | Piston-Liner Kit | Main Bearing | Thrust Bearing | Con Rod Bearing |
| 2) Engine I/F Kit | TAR83610 Consists of: | TAR74814 Std. TAR74816 .010 TAR74817 .020 TAR74818 .030 | TAR77748 Std. TAR77750 .010 TAR77751 .020 TAR77752 .030 | TAR45723 Std. TAR46396 .010 TAR46397 .020 TAR46398 .030 |
| 1) TRG18846 | a) TAR100442 b) TAR87753 c) TR41425 d) TAR63060 e) TAR98850 f) TR54114 | Use 6 | Use 1 Thrust Washer TAR77747 Std. TAR77753 .007 Use 3, Order Qty 1 | Use 6 |

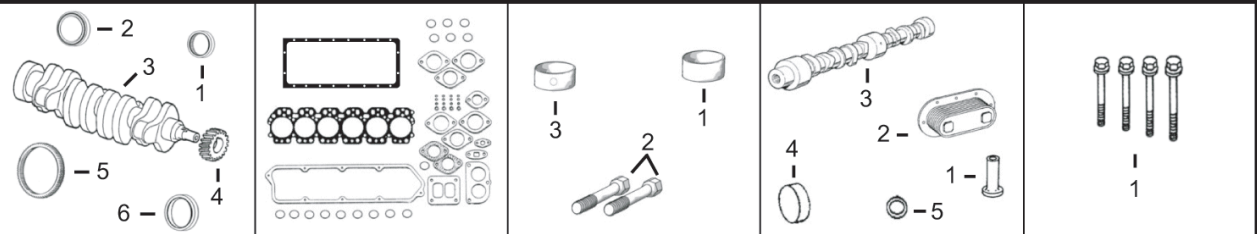

| | | | | |
|--|--|---|--|--|
| 1) Front Seal 2) Rear Seal | 1) O/H Gasket Set | 1) Bush, Con Rod 2) Bolt, Con Rod 3) Bushing, Cam | 1) Cam Follower 2) Oil Cooler 3) Camshaft Kit 4) Plug, Camshaft 5) O'ring, Oil Cooler | 1) Head Bolt Kit |
| 3) Crankshaft 4) Crankshaft, Gear 5) Ring Gear 6) Rear Gear | 2) Head Gasket Set 3) Head Gasket 4) Oil Pan Gasket | 1) TR42173 x6 2) TR66452 x12 3) TR46903 x4 (1) | 1) TR52773 2) TAR55394 3) TAR100386 4) TR26115 5) TR47153 | 1) TMX365 (2)* TMX366 (3)** |

| | | | | |
|---|---|---|---|--|
| Valve, Intake | Valve, Exhaust | Insert, Valve 1) Intake 2) Exhaust | 1) Cap, Valve 2) Lock, Valve | 1) Spring, Valve 2) Rotator, Valve 3) O'ring, Valve |
| TR43883 Std. TR45003 .003 TR45004 .015 | TR43679 Std. TR43787 .003 TR43788 .015 | 1) TR43680 Std. 2) TR43681 Std. | 1) TT20129 2) TT20077 | 1) TR26125 2) TRE11410 3) TR87627 |

| | | | | |
|-----------------------|---------------------------|--|---|--|
| Thermostat | Fuel Transfer Pump | Water Pump Rep Kit a) Without Impeller b) With Impeller | Water Pump TRE55985 (m) R71224, (m) R83561 | Pump, Oil, Quad Transmission TRE20918 For Tractors 4240,4050 |
| TR48675 180° F | TRE38009 | See Chart | | |

(1) Shape, Conrod Bushing.
 (2) **TMX365** Consists of: **TR88042** x6, **TR88043** x5, **TR88044** x8, **TR88045** x7. * With ESN > 318403.
 (3) **TMX366** Consists of: **TR88043** x11, **TR88044** x8, **TR88045** x7. ** With ESN 318404 >.
 (4) **TRE53422** will require front key **TR116311** for the front damper.