

**300 Series**  
**Engine & Equipment**  
**Model**

**4.239T**

**4 Cyl**

Bore: 4.19 in  
 106.5 mm

Pin Ø: 1.625 in  
 41 mm

**Con Rod (m):**  
 R80032, R113612,  
 R122191

**APPLICATIONS:**

**AGRICULTURAL**

- 945 2750
- 952 2755
- 1052 2755 CS/TSS
- 1155 2850
- 2140 2855
- 2450 2855N
- 2555 3430
- 2555 TSS 3830
- 2650

**CONSTRUCTION**

- 310 C/D (Turbo)
- 315 C/D (Turbo)
- 515B

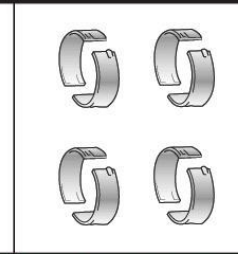
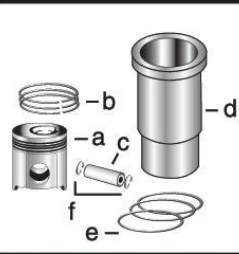

<b>1) Engine O/H Kit</b>	<b>Piston-Liner Kit</b>	<b>Main Bearing</b>	<b>Thrust Bearing</b>	<b>Con Rod Bearing</b>
<b>2) Engine I/F Kit</b>	<b>TRE33115</b> Consists of:	<b>TRE27352</b> Std.	<b>TAT21139</b> Std.	<b>TRE27348</b> Std.
<b>1) TRE54709</b>	a) <b>TRE19278</b>	<b>TRE27353</b> .010	<b>TAT21132</b> .010	<b>TRE27349</b> .010
<b>2) TIK54709</b>	b) <b>TRE66820</b>	<b>TRE27360</b> .020	<b>TAT21134</b> .020	<b>TRE27358</b> .020
	c) <b>TR124230</b>	<b>TRE27368</b> .030	<b>TAT21136</b> .030	<b>TRE27364</b> .030
	d) <b>TR116281</b>			
	e) <b>TAR65507</b>			
	f) <b>TR54114</b>	<b>Use 4</b>	<b>Use 1</b>	<b>Use 4</b>

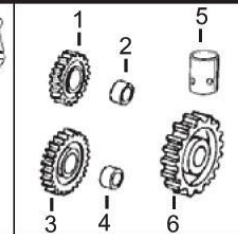
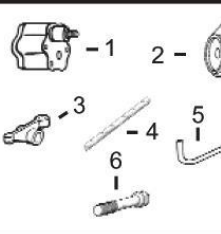
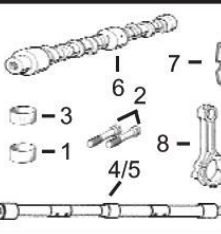
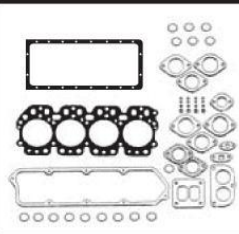
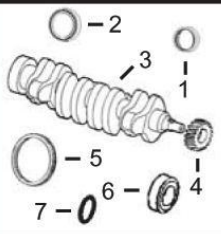

<b>1) Front Seal</b> <b>2) Rear Seal</b>	<b>1) O/H Gasket Set</b>	<b>1) Bush, Con Rod</b> <b>2) Bolt, Con Rod</b> <b>3) Bush, Bal. Shaft</b>	<b>1) Pump, Oil</b> <b>2) Oil Cooler</b> <b>3) Rocker Arm</b> <b>4) Rocker Shaft</b> <b>5) Pump, Oil Tube</b> <b>6) Cyl Hd Cap Screw</b>	<b>1) Lower Gear</b> <b>2) Lower Bushing</b> <b>3) Upper Gear</b> <b>4) Upper Bushing</b> <b>5) Cam. Follower</b> <b>6) Cam. Gear</b>
<b>3) Crankshaft</b> <b>4) Crankshaft, Gear</b> <b>5) Ring Gear</b> <b>6) Sleeve, Front</b> <b>7) Packing, Sleeve</b>	<b>2) Head Gasket Set</b> <b>3) Head Gasket</b> <b>4) Oil Pan Gasket</b> <b>5) Rocker Cover Gsk</b>	<b>4) Bal. Shaft R/H</b> <b>5) Bal. Shaft L/H</b> <b>6) Camshaft</b> <b>7) Bal. Shaft Stop</b> <b>8) Con Rod</b>		
<b>1) TAR67942</b> <b>2) TRE44574</b> <b>3) TAT18030 (1)</b> or <b>TRE20585 (4)</b> <b>4) TT20094</b> <b>5) TR114282 (142T)</b> <b>6) TR81989</b> <b>7) TH35244</b>	<b>1) TRE501579</b> <b>2) TRE38851</b> <b>3) TR125863</b> <b>4) TR97342</b> <b>5) TR73521</b>	<b>1) TR57451 x4</b> <b>2) TR80033 x8</b> <b>3) TR57160 x6 (3)</b> <b>4) TRE26282 R/H (*)</b> <b>5) TRE26283 L/H (*)</b> <b>6) TR82820 (5)</b> <b>7) TR88112</b> <b>8) TRE58347</b>	<b>1) TRE55343 (2)</b> <b>2) TRE31929</b> <b>3) TRE31973</b> <b>4) TR54987</b> <b>5) TR113752</b> <b>6) TR85363 x18 (6)</b>	<b>1) TAT24252</b> <b>2) TT26321</b> <b>3) TAT18009</b> <b>4) TT20034</b> <b>5) TT20073</b> <b>6) TT20070</b>



<b>Valve, Intake</b>	<b>Valve, Exhaust</b>	<b>Insert, Valve</b> <b>1) Intake</b> <b>2) Exhaust</b>	<b>1) Cap, Valve</b> <b>2) Lock, Valve</b>	<b>1) Spring, Valve</b> <b>2) Rotator, Valve</b> <b>3) O'ring, Valve</b>
<b>TR83071</b> Std. <b>TR89223</b> .003 <b>TR89224</b> .015	<b>TR79624</b> Std. <b>TR79625</b> .003 <b>TR79626</b> .015	<b>1) TR73064</b> Std. <b>2) TR51734</b> Std.	<b>1) TT20129</b> <b>2) TT20077</b>	<b>1) TR26125</b> <b>2) TRE11410</b> <b>3) TR87627</b>

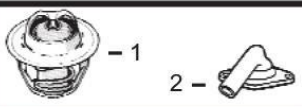

<b>1) Thermostat</b> <b>2) Thermostat Cover</b>	<b>Fuel Transfer Pump</b>	<b>Water Pump Rep Kit</b> a) Without Impeller b) With Impeller	<b>Water Pump</b>	<b>Transmission Oil Pump</b>	<b>1) Seal</b> <b>2) Injector, Pencil</b>
<b>1) TAR48675 180° F</b> <b>2) TT23620</b>	<b>TRE42211</b>	<b>See Chart</b>	<b>TAR97708</b> (m) R73604	<b>TAL120106</b>   <b>TAL68094</b>	<b>1) TR60746</b> <b>TR48000</b> <b>2) TRE37503</b>
				<b>Verify P/N for your application</b>	

(\*) If these engines use bolt on weights shafts use **TAR69710** RH and **TAR69711** LH.

(1) **TAT18030** Crankshaft 36mm (short) snout, (m) T23517.

(2) May use High Capacity Pump, Oil **TRE65580**.

(3) **TR91708** (Outer Diam. 2.00 mm / 0.078 in ) Larger and **TR57160R** (Inner Diam 0.5 mm / 0.020 in ) Smaller, are also available.

(4) **TRE20585** Crankshaft 60mm (long) snout, (m) R81959 or R121018.

(5) Threaded Type.

(6) Replace all R78558 Cap Screws with Flanged Head Cap Screw **TR85363**.