

**PowerTech**

**Engine & Equipment Model**

**6081**

**High Comp. Piston**

4801 4803

**8.1L**

Bore: 4.56 in  
116 mm  
Pin Ø: 1.85 in  
47 mm

**Con Rod (m):**

R116340 (ESN > 86,536)  
R501034 (ESN 86,537 >)

**APPLICATIONS:**

**See Index**

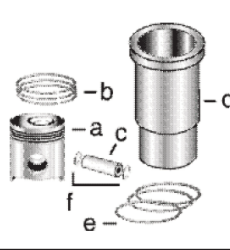

**1) Engine O/H Kit**

**Piston-Liner Kit**

**Main Bearing**

**Thrust Bearing**

**Con Rod Bearing**

**2) Engine I/F Kit**

**TRE64509**

**TRE504195 Std.**

**TRE504198 Std.**

**TR116081 Std.**

Consists of:

**TRE504196 .011**

**TRE504199 .011**

**TRE57167 .011**

**1) TOK504201**

a) **TRE70688**

**Use 6**

**Use 1**

**Use 6**

**2) TIK504201**

b) **TRE503528**

c) **TR57771**

d) **TR116236**

e) **TAR98850**

f) **TE1343FN**

**Thrust Washer**

**TRE61253 Std.**

**Use 3, Order Qty 1**

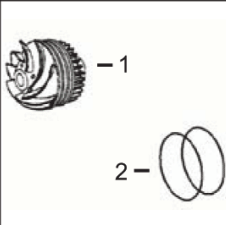
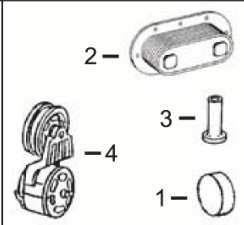
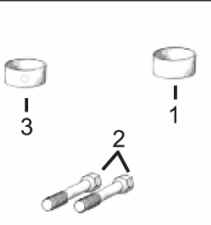
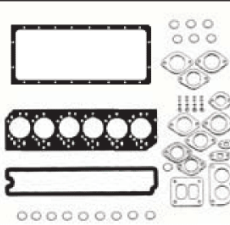
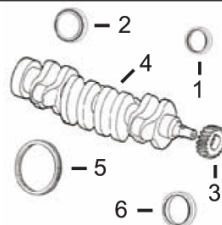

**1) Front Seal**  
**2) Rear Seal**

**1) O/H Gasket Set**

**1) Bush, Con Rod**  
**2) Bolt, Con Rod**  
**3) Bushing, Cam**

**1) Plug Camshaft**  
**2) Oil Cooler**  
**3) Tappet**  
**4) Tensioner, Belt**

**1) Pump, Water**  
**2) O'ring Mount Kit**

**3) Crankshaft Gear**  
**4) Crankshaft**  
**5) Ring Gear**  
**6) Rear Gear**

**2) Head Gasket Set**  
**3) Head Gasket**  
**4) Oil Pan Gasket**

1) **TAR49025**  
2) **TRE520036**  
3) **TR104587**  
4) **TRE535300 (1)**  
or  
**TRE534314 (2)**  
5) **TR28811**  
6) **TR63326**

1) **TRE506220**  
2) **TRE506222**  
3) **TRE55475**  
4) **TR71918 (3)**

1) **TR74008 x6**  
2) **TR66452 x12 (4)**  
3) **TR87561 x4**

1) **TR82007**  
2) **TAR55394**  
3) **TR110126**  
4) **TRE518097 (9)**  
**TRE68715 (9)**  
**TRE57498 (9)**

1) **TRE521502**  
2) **TRE509463**



Valve, Intake

Valve, Exhaust

Insert, Valve  
1) Intake  
2) Exhaust

1) Cap, Valve  
2) Lock, Valve  
3) Shield, Valve

1) Spring, Valve

**TR84618 Std.**  
**TR93308 .003**  
**TR93312 .015**

**TR84619 Std.**  
**TR93311 .003**  
**TR93313 .015**

1) **TR121193**  
2) **TR119132**

1) **TT20129**  
2) **TT20077**  
3) **TR102882 x6 (5)**  
**TR501640 x6 (6)**

1) **TR91822 (7)**  
**TR502187 (8)**



Thermostat

**TAR48675 180° F**



Pump, Oil

**TRE60622**

(1) With helical oil pump drive gear. Do not use with HPCR fuel system.

(2) With straight oil pump drive gear.

(3) With Aluminum Oil Pan use **TR49377 (RE504822)**.

(4) Use **TR66452** Rod Bolts with Machine Split Connecting Rods, and use **TR501035** Rod Bolts with Fractured Split Connecting Rods.

(5) For engine ESN 199,999 and below. For Exhaust Valves only.

(6) For engine ESN 200,000 and above. For Exhaust Valves only.

(7) For engine ESN 199,999 and below.

(8) For engine ESN 200,000 and above.

(9) Check application for proper usage.