

# PowerTech

Engine & Equipment  
Model

## 6081

Low Comp. Piston

4802 4806

8.1L

Bore: 4.56 in  
116 mm  
Pin Ø: 1.85 in  
47 mm

**Con Rod (m):**

R116340 (ESN > 86,536)  
R501034 (ESN 86,537 >)

**APPLICATIONS:**

See Index

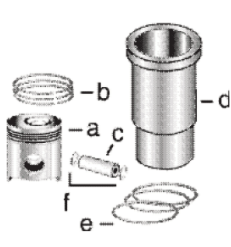

1) Engine O/H Kit

Piston-Liner Kit

Main Bearing

Thrust Bearing

Con Rod Bearing

2) Engine I/F Kit

[TRE508156](#)

[TRE504195](#) Std.

[TRE504198](#) Std.

[TR116081](#) Std.

Consists of:

[TRE504196](#) .011

[TRE504199](#) .011

[TRE57167](#) .011

1) [TOK504202](#)

a) [TRE70689](#)

Use 6

Use 1

Use 6

2) [TIK504202](#)

b) [TRE503528](#)

c) [TR57771](#)

d) [TR116236](#)

e) [TAR98850](#)

f) [TE1343FN](#)

**Thrust Washer**

[TRE61253](#) Std.

Use 3, Order Qty 1

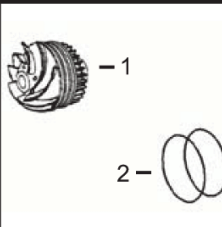
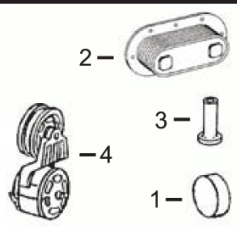
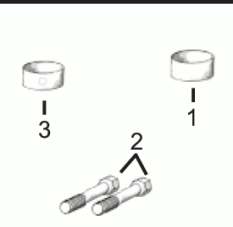
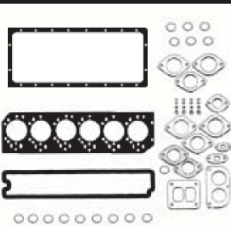
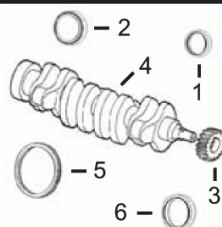

1) Front Seal  
2) Rear Seal

1) O/H Gasket Set

1) Bush, Con Rod  
2) Bolt, Con Rod  
3) Bushing, Cam

1) Plug Camshaft  
2) Oil Cooler  
3) Tappet  
4) Tensioner, Belt

1) Pump, Water  
2) O'ring Mount Kit

3) Crankshaft Gear  
4) Crankshaft  
5) Ring Gear  
6) Rear Gear

2) Head Gasket Set  
3) Head Gasket  
4) Oil Pan Gasket

1) [TAR49025](#)  
2) [TRE520036](#)  
3) [TR104587](#)  
4) [TRE535300](#) (1)  
or  
[TRE534314](#) (2)  
5) [TR28811](#)  
6) [TR63326](#)

1) [TRE506220](#)  
2) [TRE506222](#)  
3) [TRE55475](#)  
4) [TR71918](#) (3)

1) [TR74008](#) x6  
2) [TR66452](#) x12 (4)  
3) [TR87561](#) x4

1) [TR82007](#)  
2) [TAR55394](#)  
3) [TR110126](#)  
4) [TRE518097](#) (9)  
[TRE68715](#) (9)  
[TRE57498](#) (9)

1) [TRE521502](#)  
2) [TRE509463](#)



Valve, Intake

Valve, Exhaust

Insert, Valve  
1) Intake  
2) Exhaust

1) Cap, Valve  
2) Lock, Valve  
3) Shield, Valve

1) Spring, Valve

[TR84618](#) Std.  
[TR93308](#) .003  
[TR93312](#) .015

[TR84619](#) Std.  
[TR93311](#) .003  
[TR93313](#) .015

1) [TR121193](#)  
2) [TR119132](#)

1) [TT20129](#)  
2) [TT20077](#)  
3) [TR102882](#) x6 (5)  
[TR501640](#) x6 (6)

1) [TR91822](#) (7)  
[TR502187](#) (8)



Thermostat

[TAR48675](#) 180° F



Pump, Oil

[TRE60622](#)

(1) With helical oil pump drive gear. Do not use with HPCR fuel system.

(2) With straight oil pump drive gear.

(3) With Aluminum Oil Pan use [TR49377](#) (RE504822).

(4) Use [TR66452](#) Rod Bolts with Machine Split Connecting Rods, and use [TR501035](#) Rod Bolts with Fractured Split Connecting Rods.

(5) For engine ESN 199,999 and below. For Exhaust Valves only.

(6) For engine ESN 200,000 and above. For Exhaust Valves only.

(7) For engine ESN 199,999 and below.

(8) For engine ESN 200,000 and above.

(9) Check application for proper usage.