

**300 Series**  
**Engine & Equipment**  
**Model**

**6.359D**

6 Cyl

Bore: 4.19 in  
 106.5 mm  
 Pin Ø: 1.375 in  
 35 mm

**APPLICATIONS:**

**AGRICULTURAL**

955	3040	3640
975	3050	4420
985	3140	4530
1055	3150	7440
1075	3155	7445
2940	3155TSS	9900
2950	3255	9910
2955	3350	9920

**CONSTRUCTION**

444D  
 570B

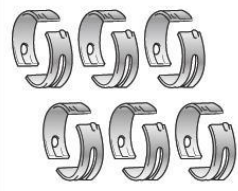
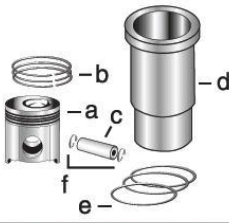

<b>1) Engine O/H Kit</b>	<b>Piston-Liner Kit</b>	<b>Main Bearing</b>	<b>Thrust Bearing</b>	<b>Con Rod Bearing</b>
--------------------------	-------------------------	---------------------	-----------------------	------------------------

<b>2) Engine I/F Kit</b>	<b>TRE30250</b>	<b>TRE27352</b> Std.	<b>TAT21139</b> Std.	<b>TRE27348</b> Std.
--------------------------	-----------------	----------------------	----------------------	----------------------

<b>1) TRE50784</b>	Consists of: a) <a href="#">TRE19282</a> b) <a href="#">TRE66820</a> c) <a href="#">TR125754</a> d) <a href="#">TR116281</a> e) <a href="#">TAR65507</a> f) <a href="#">TM41029</a>	<a href="#">TRE27353</a> .010	<a href="#">TAT21132</a> .010	<a href="#">TRE27349</a> .010
<b>2) TIK50784</b>		<a href="#">TRE27360</a> .020	<a href="#">TAT21134</a> .020	<a href="#">TRE27358</a> .020
		<a href="#">TRE27368</a> .030	<a href="#">TAT21136</a> .030	<a href="#">TRE27364</a> .030

Use 6

Use 1

Use 6

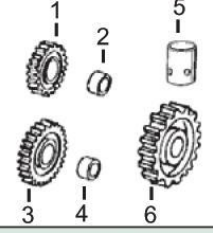
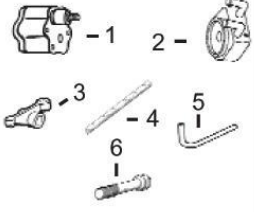
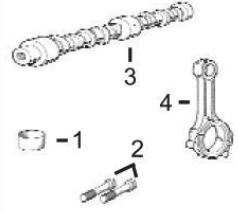
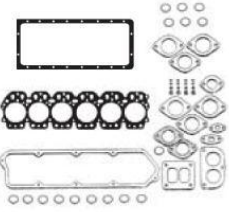
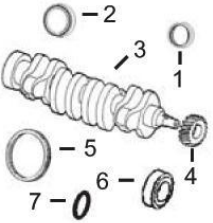

<b>1) Front Seal</b> <b>2) Rear Seal</b>	<b>1) O/H Gasket Set</b>	<b>1) Bush, Con Rod</b> <b>2) Bolt, Con Rod</b>	1) Pump, Oil 2) Oil Cooler 3) Rocker Arm 4) Rocker Shaft 5) Pump, Oil Tube 6) Cyl Hd Cap Screw	1) Lower Gear 2) Lower Bushing 3) Upper Gear 4) Upper Bushing 5) Cam. Follower 6) Cam. Gear
3) Crankshaft 4) Crankshaft, Gear 5) Ring Gear 6) Sleeve, Front 7) Packing, Sleeve	2) Head Gasket Set 3) Head Gasket 4) Oil Pan Gasket 5) Rocker Cover Gsk	3) Camshaft 4) Con Rod		

1) <a href="#">TAR67942</a> 2) <a href="#">TRE44574</a> 3) <a href="#">TAT22562</a> 4) <a href="#">TT20094</a> 5) <a href="#">TR28811</a> (129T) 6) <a href="#">TR81989</a> 7) <a href="#">TH35244</a>	1) <a href="#">TRE501580</a> 2) <a href="#">TRE38852</a> 3) <a href="#">TR114157</a> 4) <a href="#">TR97344</a> 5) <a href="#">TR75728</a>	1) <a href="#">TR55647</a> x6 2) <a href="#">TR80033</a> x12 3) <a href="#">TR82821</a> (3) 4) <a href="#">TRE16495</a>	1) <a href="#">TRE55343</a> (2) 2) <a href="#">TRE31929</a> 3) <a href="#">TRE31973</a> 4) <a href="#">TR54986</a> 5) <a href="#">TR113752</a> 6) <a href="#">TR85363</a> x26 (4)	1) <a href="#">TAT24252</a> 2) <a href="#">TT26321</a> 3) <a href="#">TAT18009</a> 4) <a href="#">TT20034</a> 5) <a href="#">TT20073</a> 6) <a href="#">TT20070</a>
--	--	--	--	--



Valve, Intake	Valve, Exhaust	Insert, Valve 1) Intake 2) Exhaust	1) Cap, Valve 2) Lock, Valve	1) Spring, Valve 2) Rotator, Valve 3) O'ring, Valve
<a href="#">TR79623</a> Std. <a href="#">TR79628</a> .003 <a href="#">TR79629</a> .015	<a href="#">TR79624</a> Std. <a href="#">TR79625</a> .003 <a href="#">TR79626</a> .015	1) <a href="#">TR73064</a> Std. 2) <a href="#">TR51734</a> Std.	1) <a href="#">TT20129</a> 2) <a href="#">TT20077</a>	1) <a href="#">TR26125</a> 2) <a href="#">TRE11410</a> 3) <a href="#">TR87627</a>



Thermostat	Fuel Transfer Pump	Water Pump Repair Kit		Transmission Oil Pump		1) Seal 2) Injector, Pencil 1) <a href="#">TR60746</a> <a href="#">TR48000</a> 2) <a href="#">TAR89564</a>
<a href="#">TAR48675</a> 180° F (1)	<a href="#">TRE42211</a>	Without Impeller	With Impeller	<a href="#">TAL120106</a>	<a href="#">TAL68094</a>	
		See Chart		Verify P/N for your application		

(1) Saran engines may use [TRE64354](#).  
 (2) Some Engines Models may use High Capacity Pump, Oil [TRE65580](#).  
 (3) Threaded Type.  
 (4) Replace all R78558 Cap Screws with Flanged Head Cap Screw [TR85363](#).

**CALL BELL'S ENGINES NOW ON: (08) 9581 7944**