

**Engine & Equipment  
Application**

**1004.40T**

**TURBOCHARGED**

**4 Cyl, Lip Seal**

Bore: 3.937 in  
100 mm

To ESN U608300W (1992)

**APPLICATIONS:**

**JCB**

3CX Backhoe (AB50609)  
3CX Backhoe (AB50279)  
415 Loader (AB50253)

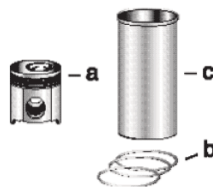

**1) Engine O/H Kit**

**Piston-Liner Kit**

**Main Bearing Set**

**Con Rod Bearing Set**

**Thrust Washer Set**

**2) Basic Engine Kit**

**PCK245**  
Consists of:  
a) [PMXF0013](#)  
b) [P4181A021](#)  
c) [P3135X042 \(1\)](#)  
**4 Per Engine**

[P81558](#) Std.  
[P81558A](#) .010  
[P81558B](#) .020  
[P81558C](#) .030  
**Set of 5 Pairs**

[PU5ME0006](#) Std.  
[PU5ME0006A](#) .010  
[PU5ME0006B](#) .020  
[PU5ME0006C](#) .030  
**Set of 4 Pairs**

[P31137551/61](#)  
**Set of 2 Pairs**

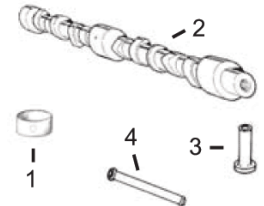
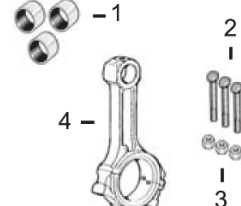
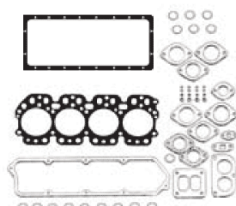
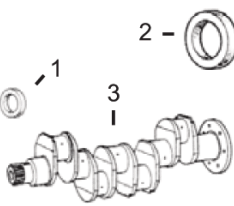

**1) Front Seal**  
**2) Rear Seal**

**1) Top Gasket Set**  
**2) Bottom Gasket**  
**3) Valve Cover Gsk**

**1) Bush, Con Rod**  
**2) Bolt, Con Rod**  
**3) Nut, Con Rod**

**1) Bushing, Cam**

**3) Crankshaft Kit**

**4) Head Gasket**  
**5) Oil Pan Set**

**4) Con Rod**

**2) Camshaft**  
**3) Tappet**  
**4) Push Rod**

1) [P2418F436](#)  
2) [P2418F475](#)  
3) [PZZ90212](#)

1) [PU5LT0178](#)  
2) [PU5LB0152](#)  
3) [P3681A021](#)  
4) [P3681E025](#)  
5) [PU5MK0600](#)

1) [P31134131](#) x4  
2) [P32762144](#) x8  
3) [P33221328](#) x8  
4) [PZZ90013 \(3\)](#)  
[PZZ90058 \(3\) \(4\)](#)

1) [P31134132](#) x1  
2) [P31415361](#)  
3) [P31434163](#)  
4) [P31434307](#)

**Valve Train Kit**

1) Valve, Intake  
2) Valve, Exhaust

3) Guide, Valve  
a) Intake  
b) Exhaust

4) Spring, Valve (2)  
a) Inner  
b) Outer

5) Lock, Valve  
6) Seal, Valve

**[PVTK416](#)**

1) [P3142L071](#) x4  
2) [P3142A051](#) x4

a) [P3343F002](#) x4  
b) [P3343J002](#) x4

a) [P31744133](#) x8  
b) [P31745122](#) x8

5) [P33173108](#) x16  
6) [P33817117](#) x8

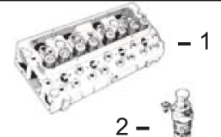
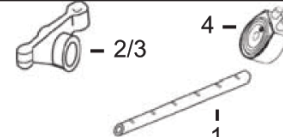
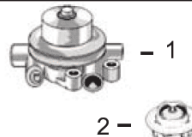
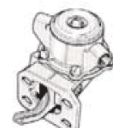
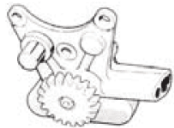
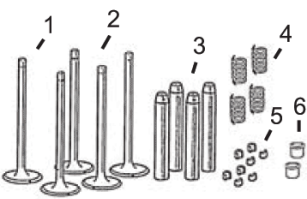

**Oil Pump**

**Lift Pump**

**1) Water Pump**  
**2) Thermostat**

**1) Rocker Shaft**  
**2) Rocker Arm LH**  
**3) Rocker Arm RH**  
**4) Oil Cooler**

**1) Cylinder Head**  
**2) Glowplug**

[P4132F056](#)

[P2641A067](#)

1) [P4131E012](#)  
2) [P2485613](#)

1) [PZZ90032](#)  
2) [P41151483](#)  
3) [P41151484](#)  
4) [P2486A222 \(5\)](#)

1) N/A  
2) [P2666108](#)  
**(Bayonet Fitting)**

(1) Flanged, Semi Finished Liner available, [P3135X041](#).

(2) Use Single Spring, Valve [3174P405](#) for low speed applications (Not available from Maxiforce).

(3) Check with Build List.

(4) Fracture Split Type

(5) Applies to AB50609 ONLY.