

Engine & Equipment Application

1004.40T

TURBOCHARGED / INTERCOOLED

4 Cyl, Lip Seal

Bore: 3.9370 in
100.00 mm

Stroke: 5.00 in
127.00 mm

GRADE "L"

Piston height: 70.161 mm
2.762 in

APPLICATIONS:

YE Builds and some **YD** builds used in **Emission Controlled** Areas

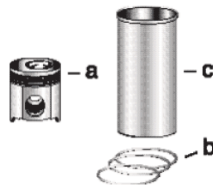

1) Engine O/H Kit

Piston-Liner Kit

Main Bearing Set

Con Rod Bearing Set

Thrust Washer Set

2) Basic Engine Kit

PCK624
Consists of:
a) [PU5LF0024](#)
b) [P4181A026](#)
c) [P3135X062](#) (1)
4 Per Engine

[P81558](#) Std.
[P81558A](#) .010
[P81558B](#) .020
[P81558C](#) .030
Set of 5 Pairs

[PU5ME0006](#) Std.
[PU5ME0006A](#) .010
[PU5ME0006B](#) .020
[PU5ME0006C](#) .030
Set of 4 Pairs

[P31137551/61](#)
Set of 2 Pairs

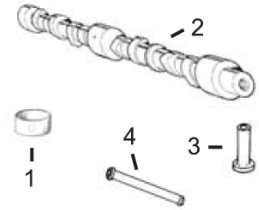
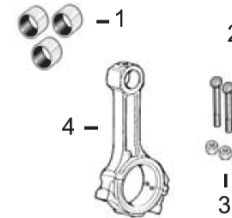
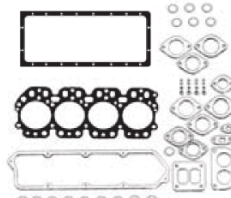
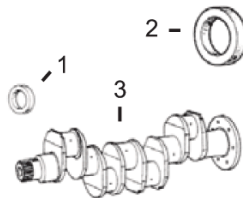

**1) Front Seal
2) Rear Seal**

**1) Top Gasket Set
2) Bottom Gasket
3) Valve Cover Gsk**

**1) Bush, Con Rod
2) Bolt, Con Rod
3) Dowel, Con Rod**

1) Bushing, Cam

3) Crankshaft Kit

**4) Head Gasket
5) Oil Pan Set**

4) Con Rod

**2) Camshaft
3) Tappet
4) Push Rod**

1) [P2418F436](#)
2) [P2418F475](#)
3) [PZZ90212](#)

1) [PU5LT0178](#)
2) [PU5LB0152](#)
3) [P3681A021](#)
4) [P3681E025](#)
5) [PU5MK0600](#)

1) [P3112E005](#) x4 (2)
2) [P32186142](#) x8
3) [P3246A001](#) x8
4) [PZZ90146](#)

1) [P31134132](#) x1
2) [P31415361](#)
3) [P31434163](#)
4) [P31434307](#)

Valve Train Kit

1) Valve, Intake
2) Valve, Exhaust

3) Guide, Valve
a) Intake
b) Exhaust

4) Spring, Valve
a) Inner
b) Outer

5) Lock, Valve
6) Seal, Valve

[PVTK417](#)

1) [P3142L072](#) x4
2) [P3142A051](#) x4

a) [P3343F002](#) x4
b) [P3343J002](#) x4

a) [P31744133](#) x8
b) [P31745122](#) x8

5) [P33173108](#) x16
6) [P33817117](#) x8

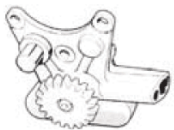
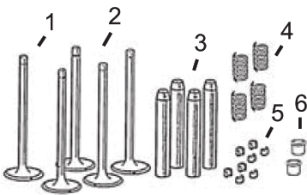

Oil Pump

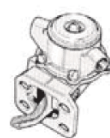

Lift Pump

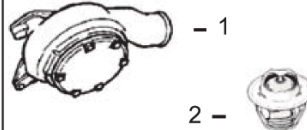

1) Water Pump
2) Thermostat

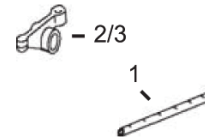

1) Rocker Shaft
2) Rocker Arm LH
3) Rocker Arm RH

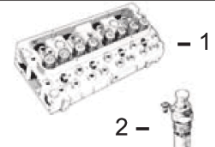

1) Cylinder Head
2) Glowplug

[P4132F056](#)

[P2641A067](#)

1) [P4131E012](#)
2) [P2485613](#)

1) [PZZ90032](#)
2) [P41151483](#)
3) [P41151484](#)

1) N/A
2) [P2666108](#)
(Bayonet Fitting)

(1) Flanged, Semi Finished Liner available, [P3135X063](#).

(2) Use with Con Rod [PZZ90146](#).

(3) 30° Angle.