

**Engine & Equipment  
Application**

**1006.60**

**6 Cyl, Lip Seal**

**Kits include both rear seals**

Bore: 3.9370 in  
100.00 mm

**APPLICATIONS:**

**HYSTER**  
H165-280 Forklift (YA70217)

**JCB**  
Wheeled Loader (YA50214)  
Industrial (YA50339)

**MF AGRICULTURAL**  
396 (YA31257)  
399 (YA31240)

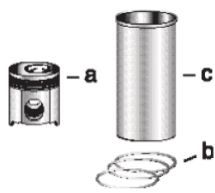

**1) Engine O/H Kit**

**Piston-Liner Kit**

**Main Bearing Set**

**Con Rod Bearing Set**

**Thrust Washer Set**

**2) Basic Engine Kit**

**PCK142**  
Consists of:  
a) [PMXF0015](#)  
b) [P4181A019](#)  
c) [P3135X042](#) (1)  
**6 Per Engine**

[PU5MB0030](#) Std.  
[PU5MB0030A](#) .010  
[PU5MB0030B](#) .020  
[PU5MB0030C](#) .030  
**Set of 7 Pairs**

[P85043](#) Std.  
[P85043A](#) .010  
[P85043B](#) .020  
[P85043C](#) .030  
**Set of 6 Pairs**

[P31137551/61](#)  
**Set of 2 Pairs**

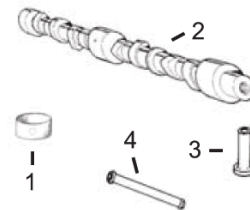
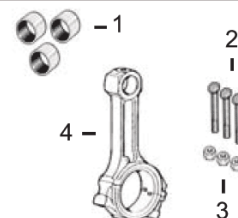
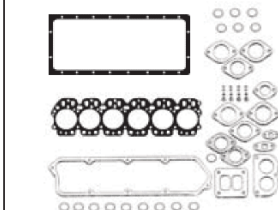
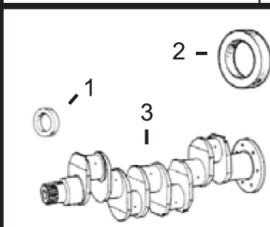

**1) Front Seal**  
**2) Rear Seal**

**1) Top Gasket Set**  
**2) Bottom Gasket**

**1) Bush, Con Rod**  
**2) Bolt, Con Rod**  
**3) Nut, Con Rod**

**1) Bushing, Cam**

**3) Crankshaft Kit**

**3) Head Gasket**

**4) Con Rod**

**2) Camshaft**  
**3) Tappet**  
**4) Push Rod**

1) [P2418F436](#)  
2) [P2418F475](#) (3)  
[P2418F701](#) (4)  
3) [PZZ90087](#)

1) [PU5LT1179](#)  
2) [PU5LB0153](#)  
3) [P3681H205](#)

1) [P31134123](#) x6  
2) [P32762144](#) x12  
3) [P33221328](#) x12  
4) [PZZ90009](#)

1) [P31134132](#) x1  
2) [P31416307](#)  
3) [P31434163](#)  
4) [P31434307](#)

**Valve Train Kit**

1) Valve, Intake  
2) Valve, Exhaust

3) Guide, Valve  
a) Intake  
b) Exhaust

4) Spring, Valve (2)  
a) Inner  
b) Outer

5) Lock, Valve  
6) Seal, Valve

**PVTK612**

1) [P3142L051](#) x6  
2) [P3142A051](#) x6

a) [P3343F002](#) x6  
b) [P3343J002](#) x6

a) [P31744133](#) x12  
b) [P31745122](#) x12

5) [P33173108](#) x24  
6) [P33817117](#) x12

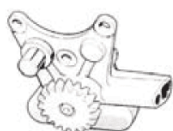
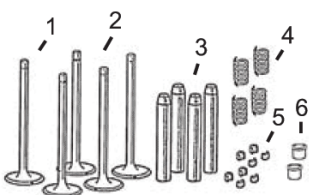

**Oil Pump**

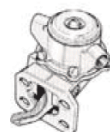

**Lift Pump**

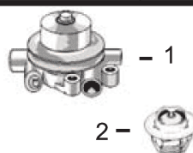

1) **Water Pump**  
2) **Thermostat**

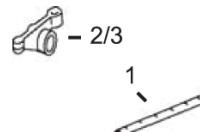

1) **Rocker Shaft**  
2) **Rocker Arm LH**  
3) **Rocker Arm RH**



1) **Cylinder Head**  
2) **Glowplug**

[P4132F043](#)

[P2641729](#)

1) [PU5MW0092](#)  
2) [P2485613](#) x2

1) N/A  
2) [P41151483](#)  
3) [P41151484](#)

1) N/A  
2) [P2666108](#)  
(Bayonet Fitting)

(1) Flanged, Semi Finished Liner available, [P3135X041](#).

(2) Use Single Valve Spring, 3174P405 for low speed applications, not available from Maxiforce.

(3) To ESN U764751H.

(4) From ESN U764752H.