

**Engine & Equipment
Application**

104-22
(KR, KRC, KRG)

NATURALLY ASPIRATED

4 Cyl

Bore: 3.3 in
84.00 mm

Stroke: 3.9 in
100.00 mm

Displacement: 135 in³
2.216 Liter

Compression Ratio: 22:1

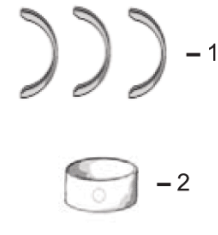

1) Engine O/H Kit	Piston Kit Ring Set	Main Bearing Set	Con Rod Bearing Set	1) Thrust Washer 2) Crank Bushing
2) Basic Engine Kit	P115017491 Std. P115017491B 0.50	P198586140 Std. P198586150 .010 P198586160 .020	PU5ME0011 Std. PU5ME0011A .010 PU5ME0011B .020	1) P199266200/10 Set of 3 Pcs 2) P198517222 Std. P198517226 .010 P198517229 .020
1) POK404 Std. POK405 0.50	1) P115107970 Std. P115107970B 0.50			
2) PBK404 Std. PBK405 0.50	4 Per Engine	Set of 4 Pairs	Set of 4 Pairs	

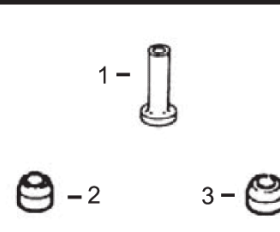
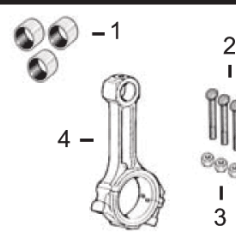
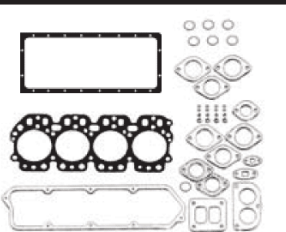
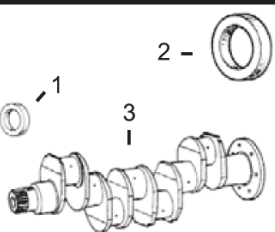

1) Front Seal 2) Rear Seal	1) O/H Gasket Set	1) Bush, Con Rod 2) Bolt, Con Rod 3) Nut, Con Rod	1) Tappet 2) Seal, Intake Valve 3) Seal, Exhaust Valve
3) Crankshaft Kit	2) Cylinder Head Gasket 3) Seal Rocker Box 4) Seal, Cyl Head Cover 5) Oil Pan Gasket	4) Con Rod	
1) P198636160 2) P050209083 3) P115256990	1) PU5LC0017 (1) 2) P111147741 3) P120996130 4) P111996401 5) P110996920	1) P198517265 x4 2) P115176140 x8 3) P020109120 x8 4) P115026330	1) P120116160 2) P120406070 x4 3) P120406050 x4

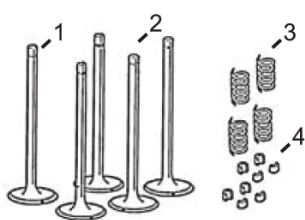

Valve Train Kit	1) Valve, Intake 2) Valve, Exhaust	3) Spring, Valve	4) Lock, Valve
PVTK440	1) P120166350 x4 2) P120176360 x4	3) P198216700 x8	4) P120226070 x16

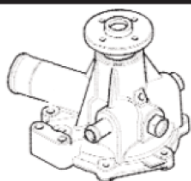

Water Pump

Oil Pump

Thermostat

Repair Sleeve

[P145017951](#)

[PU5MK8266](#)

[P145206182](#)

[84RS](#)

(1) Does not include Crankshaft Oil Seals.