

Engine & Equipment Application



1103C - 33 (DC)
1103D - 33 (XK)

NATURALLY ASPIRATED

Bore: 4.133 in
 105.00 mm

Stroke: 5.00 in
 127.00 mm

Displacement: 201 in³
 3.3 Liter

1) Engine O/H Kit	Piston & Ring Kit	Main Bearing Set	Con Rod Bearing Set	Thrust Washer Set			
2) Basic Kit	P4115P011 Std.	PU5MB0019 Std.	PU5ME0018 Std.	P31137551/61			
1) POK331 Std.	3 Per Engine	Set of 4 Pairs	Set of 3 Pairs	Set of 2 Pairs			
POK332 0.50					P4115P012 0.50 mm	PU5MB0019A .010	PU5ME0018A .010
POK333 1.00					P4115P013 1.00 mm	PU5MB0019B .020	PU5ME0018B .020
2) PBK331 Std.		PU5MB0019C .030	PU5ME0018C .030				
PBK332 0.50							
PBK333 1.00							

*** Piston Kit consists of:**

1) 1 X PMXFP011 Piston Std,	1 X PUPRK0003 Ring Set Std.
2) 1 X PMXFP012 Piston 0.50 mm,	1 X PUPRK0003B Ring Set 0.50 mm.
3) 1 X PMXFP013 Piston 1.00 mm,	1 X PUPRK0003D Ring Set 1.00 mm.

APPLICATIONS:

Used in Wheeled Tractors

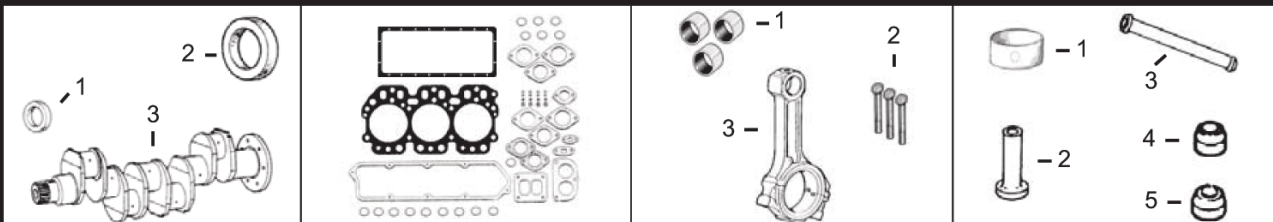

1) Front Seal 2) Rear Seal	1) Top Gasket Set 2) Bottom Gasket	1) Bush, Con Rod 2) Bolt, Con Rod	1) Bushing, Cam
3) Crankshaft Kit	3) Head Gasket 4) Valve Cover Gasket 5) Oil Pan Gasket	3) Con Rod Kit	2) Tappet 3) Push Rod 4) Seal, Exhaust Valve 5) Seal, Intake Valve
1) P2418F436 2) P2418F704 3) P4181V017	1) PU5LT0355 2) PU5LB0380 3) P3681E049 4) P3681A057 5) P3681K038	1) P3112A005 x3 2) P3212V003 x6 3) P4115C314 (2)	1) P3112D071 x1 2) P31434163 3) P31434307 4) P2418M517 x3 5) P2418M519 x3

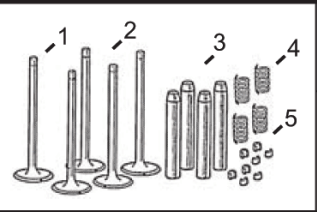

Valve Train Kit	1) Valve, Intake 2) Valve, Exhaust	3) Guide, Valve (Intake & Exhaust)	4) Spring, Valve	5) Lock, Valve
PVTK307	1) P3142H071 x3 2) P3142A151 x3	3) P3313A012 x6	4) P3174A016 x6	5) P3142W004 x12

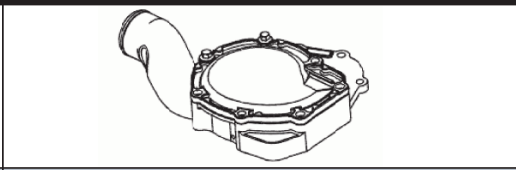
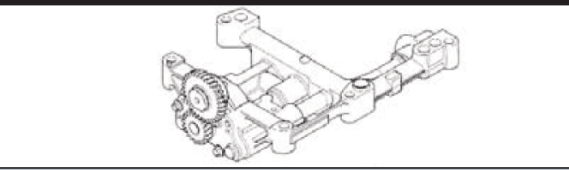

Oil Pump

Water Pump

Water Pump Gasket

[P4132F071](#) (1) (3)
[P4132F072](#) (3)

[PU5MW0197](#)

[P3682A011](#)

(1) Not to be used on engines with balancer units.
 (2) Grade J, Color Coded Green.
 (3) Check with Build List.