

**Engine & Equipment
Application**

1104A - 44T
(RS)
TURBOCHARGED

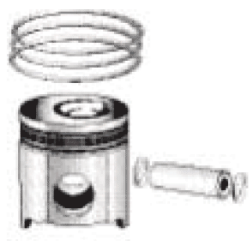

Bore: 4.133 in
105.00 mm

Stroke: 5.00 in
127.00 mm

Displacement: 269 in³
4.4 Liter

APPLICATIONS:

GENSETS

1) Engine O/H Kit	Piston & Ring Kit	Main Bearing Set	Con Rod Bearing Set	Thrust Washer Set			
2) Basic Kit	P4115P025 Std.	PU5MB0018 Std.	PU5ME0013 Std.	P31137551/61			
1) POK427 Std.	4 Per Engine	Set of 5 Pairs	Set of 4 Pairs	Set of 2 Pairs			
POK428 0.50					P4115P026 0.50 mm	PU5MB0018A .010	PU5ME0013A .010
POK429 1.00					P4115P027 1.00 mm	PU5MB0018B .020	PU5ME0013B .020
2) PBK427 Std.		PU5MB0018C .030	PU5ME0013C .030				
PBK428 0.50							
PBK429 1.00							

*** Piston Kit consists of:**

1) 1 X PMXFP025	Piston Std,	1 X PUPRK0002	Ring Set Std.
2) 1 X PMXFP026	Piston 0.50 mm,	1 X PUPRK0002B	Ring Set 0.50 mm.
3) 1 X PMXFP027	Piston 1.00 mm,	1 X PUPRK0002D	Ring Set 1.00 mm.

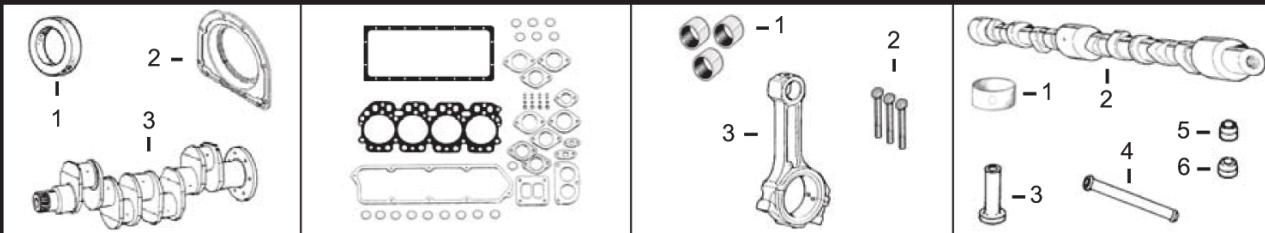

1) Front Seal 2) Rear Seal	1) Top Gasket Set 2) Bottom Gasket	1) Bush, Con Rod 2) Bolt, Con Rod	1) Bushing, Cam
3) Crankshaft Kit	3) Head Gasket 4) Valve Cover Gasket 5) Oil Pan Gasket	3) Con Rod Kit	2) Camshaft 3) Tappet 4) Pushrod 5) Seal, Exhaust Valve 6) Seal, Intake Valve
1) P2418F436 2) P2418F704 3) PZZ90239	1) PU5LT0357 2) PU5LB0382 3) P3681E051 4) P3681A055 5) P3681K037	1) P3112A005 x4 2) P3212V003 x8 3) P4115C314 (2)	1) P3112D071 x1 2) P3141D211 3) P31434163 4) P31434307 5) P2418M517 x4 6) P2418M519 x4

Valve Train Kit	1) Valve, Intake 2) Valve, Exhaust	3) Guide, Valve (Intake & Exhaust)	4) Spring, Valve	5) Lock, Valve
PVTK425	1) P3142H071 x4 2) P3142A151 x4	3) P3313A012 x8	4) P3174A016 x8	5) P3142W004 x16

Oil Pump	Water Pump	Water Pump Gasket
P4132F071 (1)	PU5MW0194	P3682A011

(1) Not to be used on engines with balancer units.
(2) Grade J, Color Coded Green.