

**Engine & Equipment
Application**

1104D - 44
(NK)

**NATURALLY
ASPIRATED**

Bore: 4.133 in
105.00 mm

Stroke: 5.00 in
127.00 mm

Displacement: 269 in³
4.4 Liter

APPLICATIONS:

AG Tractors
Backhoe Loaders
Forklifts
Telehandlers



1) Engine O/H Kit	Piston & Ring Kit	Main Bearing Set	Con Rod Bearing Set	Thrust Washer Set
2) Basic Kit	PU5PR0063 Std.	PU5MB0033 Std.	PU5ME0034 Std.	P31137551/61
1) POK506 Std.	4 Per Engine	Set of 5 Pairs	Set of 4 Pairs	Set of 2 Pairs
POK507 0.50				
POK508 1.00				
2) PBK506 Std.				
PBK507 0.50				
PBK508 1.00				

*** Piston Kit consists of:**

1) 1 X PMXFP063 Piston Std,	1 X PUPRK0003 Ring Set Std.
2) 1 X PMXFP063B Piston 0.50 mm,	1 X PUPRK0003B Ring Set 0.50 mm.
3) 1 X PMXFP063D Piston 1.00 mm,	1 X PUPRK0003D Ring Set 1.00 mm.

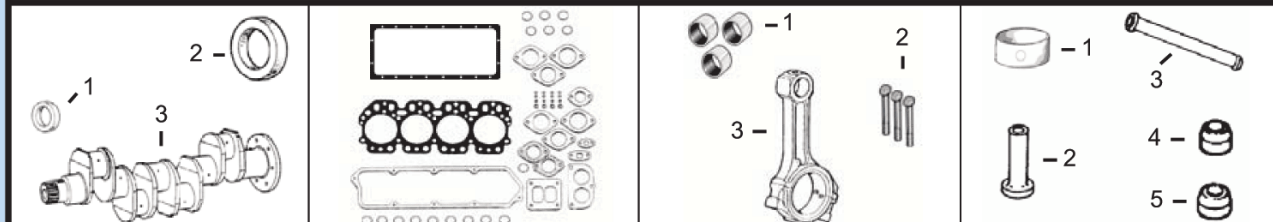

1) Front Seal 2) Rear Seal	1) Top Gasket Set 2) Bottom Gasket	1) Bush, Con Rod 2) Bolt, Con Rod	1) Bushing, Cam
3) Crankshaft Kit	3) Head Gasket 4) Valve Cover Gasket 5) Oil Pan Gasket	3) Con Rod Kit	2) Tappet 3) Push Rod 4) Seal, Exhaust Valve 5) Seal, Intake Valve
1) P2418F436 2) P2418F704 3) PZZ90239	1) PU5LT0357 2) PU5LB0383 3) P3681E051 4) P3681A055 5) P3681K037	1) P3112A005 x4 2) P3212V003 x8 3) P4115C314 (2)	1) P3112D071 x1 2) P3142U061 3) P3142V011 4) P2418M517 x4 5) P2418M519 x4

Valve Train Kit	1) Valve, Intake 2) Valve, Exhaust	3) Guide, Valve (Intake & Exhaust)	4) Spring, Valve	5) Lock, Valve
PVTK426	1) P3142H101 x4 2) P3142A171 x4	3) P3313A012 x8	4) P3174A031 x8	5) P2714A002 x16

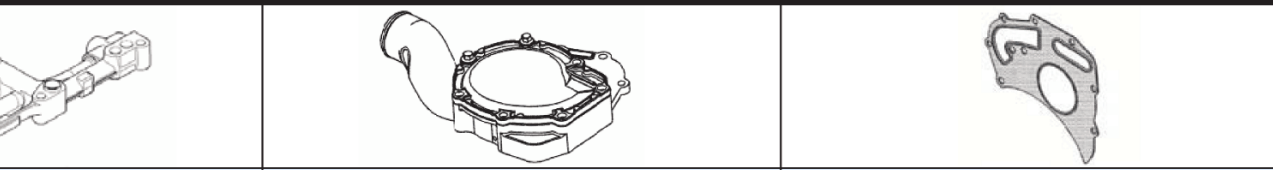

Oil Pump	Water Pump	Water Pump Gasket
P4132F073 (1)	PU5MW0208	P3682A011

(1) Not to be used on engines with balancer units.
(2) Grade J, Color Coded Green.