

Engine & Equipment Application

4.236

4 Cyl, Rope & Lip Seal

Bore: 3.8770 in
98.476 mm

To ESN U106654N

APPLICATIONS:

JCB

3CX Backhoe (LD50096)
410 Loader (LD50105)
520 Handler (LD50103)

LANDINI TRACTORS

6500/6550 (LD22573)
6830/7830
7500/7550 (LD22574)

MF AGRICULTURAL

175 (LD20022)
255 (LD22694/5)
275 (LD22051/2)

MF INDUSTRIAL

50C (LD22824)
6000 Forklift (LD22055)

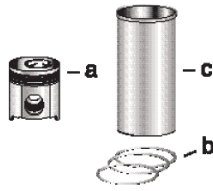

1) Engine O/H Kit

Piston-Liner Kit

Main Bearing Set

Con Rod Bearing Set

Thrust Washer Set

2) Basic Engine Kit

[PU5MK0123](#)

[P81558](#) Std.

[P85042](#) Std.

[P31137551/61](#)

Consists of:

1) [POK446](#)

a) [P68301](#)

[P81558A](#) .010

[P85042A](#) .010

2) [PBK446](#)

b) [P41158041](#)

[P81558B](#) .020

[P85042B](#) .020

c) [P31358394](#) (3)

[P81558C](#) .030

[P85042C](#) .030

4 Per Engine

Set of 5 Pairs

Set of 4 Pairs

Set of 2 Pairs

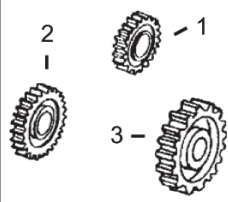
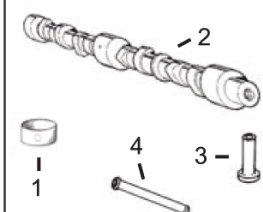
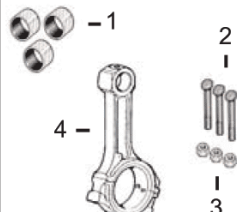
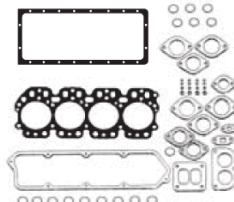
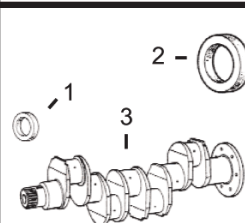

1) Front Seal

1) Top Gasket Set

1) Bush, Con Rod

1) Bushing, Cam

1) Crankshaft Gear

2) Rear Seal

2) Bottom Gasket

2) Bolt, Con Rod

2) Camshaft

2) Camshaft Gear

3) Crankshaft Kit

3) Valve Cover Gsk

3) Nut, Con Rod

3) Tappet

3) Idler Gear

1) [P2418F436](#)

1) [PU5LT0015](#)

1) [P31134123](#) x4

1) [P31134132](#) x1

1) [P31171681](#)

2) [P2418F475](#)

2) [PU5LB0045](#)

2) [P32762144](#) x8

2) [P31415321](#)

2) [P31171353](#)

[P36883108](#) x2

3) [P3681A027](#)

3) [P33221328](#) x8

3) [P31434163](#)

3) [P41115023](#)

3) [PZZ90093](#) (4)

4) [P36812349](#)

4) [PZZ90009](#)

4) [P31434307](#)

[PZZ90081](#) (5)

5) [PU5MK0600](#)

Valve Train Kit

1) Valve, Intake
2) Valve, Exhaust

3) Guide, Valve
a) Intake
b) Exhaust

4) Spring, Valve
a) Inner
b) Outer

5) Lock, Valve
6) Seal, Valve

[PVTK406](#)

1) [P31431641](#) x4
2) [P31431881](#) x4

a) [P3343F002](#) x4
b) [P3343J002](#) x4

a) [P31744131](#) x8
b) [P31745121](#) x8

5) [P33173108](#) x16
6) [P33817117](#) x8

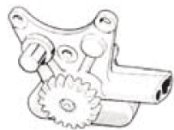
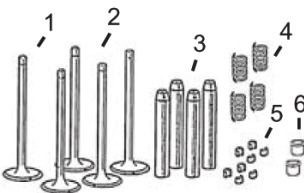

Oil Pump

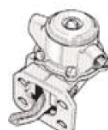

Lift Pump

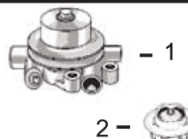

1) Water Pump
2) Thermostat

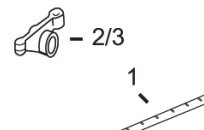

1) Rocker Shaft
2) Rocker Arm LH
3) Rocker Arm RH



1) Cylinder Head (With Valves)
2) Glowplug



Balancer Unit

[P41314182](#) (1)

[P2641338](#) (6)
[P2641728](#) (7)

1) [P4131A013](#)
2) [P2485659](#)
[P2485666](#)
(Use on JCB)

1) [PZZ90032](#)
2) [P41151483](#)
3) [P41151484](#)

1) [PZZ80175](#)
2) [P2666103](#)
(Screw Fitting)
[P2666108](#)
(Bayonet Fitting)

[P41733082](#) (2)

(1) For Non Agricultural Uses.

(2) For Agricultural Uses.

(3) Parallel, Semi Finished Liner, [P31358324](#), Flanged, Semi Finished Liner, [P31358393](#),

and Finished Liner in .010" Oversize. [P31358398](#) are also available.

(4) Rope seal crank used To ESN 136318L.

(5) Lip seal crank used From ESN 136319L.

(6) To Engine No: 236UA57134.

(7) From Engine No: 236UA57135.