

Engine & Equipment
Application

4.248

4 Cyl

Both rear seal types in kit

Bore: 3.9785 in
101.054 mm

To ESN UA123423L

APPLICATIONS:

MF AGRICULTURAL
275 Tractor

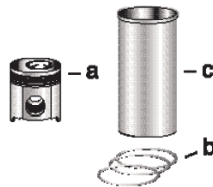

1) Engine O/H Kit

Piston-Liner Kit

Main Bearing Set

Con Rod Bearing Set

Thrust Washer Set

2) Basic Engine Kit

[PU5MK0067](#)

[P81558](#) Std.

[P85042](#) Std.

[P31137551/61](#)

Consists of:

1) [POK460](#)

a) [P89207](#)

[P81558A](#) .010

[P85042A](#) .010

b) [P4181A009](#)

[P81558B](#) .020

[P85042B](#) .020

2) [PBK460](#)

c) [P31358352](#) (1)

[P81558C](#) .030

[P85042C](#) .030

4 Per Engine

Set of 5 Pairs

Set of 4 Pairs

Set of 2 Pairs

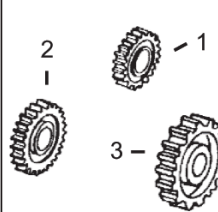
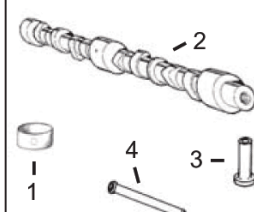
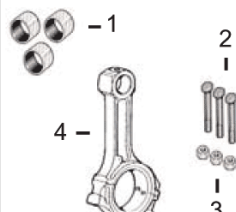
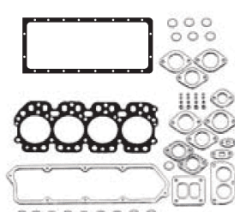
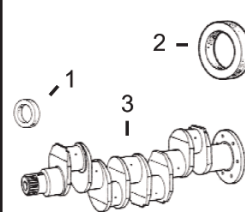

1) Front Seal
2) Rear Seal

1) Top Gasket Set
2) Bottom Gasket
3) Valve Cover Gsk

1) Bush, Con Rod
2) Bolt, Con Rod
3) Nut, Con Rod

1) Bushing, Cam
2) Camshaft
3) Tappet
4) Push Rod

1) Crankshaft Gear
2) Camshaft Gear
3) Idler Gear

3) Crankshaft Kit

4) Head Gasket
5) Oil Pan Set
6) Timing Cover Gsk

4) Con Rod

1) [P2418F436](#)
2) [P36883108](#) x2 (2)
[P2418F475](#) (3)
3) [PZZ90093](#) (2)
[PZZ90081](#) (3)

1) [PU5LT0015](#)
2) [PU5LB0045](#)
3) [P3681A027](#)
4) [P36812349](#)
5) [PU5MK0600](#)
6) [P3681P045](#)

1) [P31134123](#) x4
2) [P32762144](#) x8
3) [P33221328](#) x8
4) [PZZ90009](#)

1) [P31134132](#) x1
2) [P31415321](#)
3) [P31434163](#)
4) [P31434307](#)

1) [P31171681](#)
2) [P31171353](#)
3) [P41115023](#)

Valve Train Kit

1) Valve, Intake
2) Valve, Exhaust

3) Guide, Valve
a) Intake
b) Exhaust

4) Spring, Valve
a) Inner
b) Outer

5) Lock, Valve
6) Seal, Valve

[PVTK406](#)

1) [P31431641](#) x4
2) [P31431881](#) x4

a) [P3343F002](#) x4
b) [P3343J002](#) x4

a) [P31744131](#) x8
b) [P31745121](#) x8

5) [P33173108](#) x16
6) [P33817117](#) x8

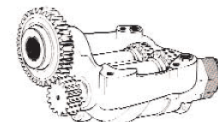
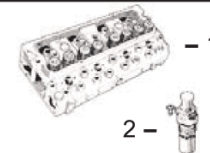
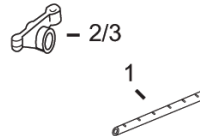
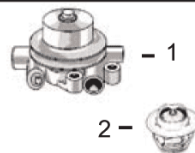
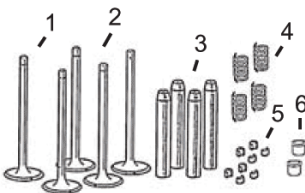

Lift Pump

1) Water Pump
2) Thermostat

1) Rocker Shaft
2) Rocker Arm LH
3) Rocker Arm RH

1) Cylinder Head (With Valves)
2) Glowplug

Balancer Unit

[P2641728](#)

1) [P4131A013](#)
2) [P2485659](#)

1) [PZZ90032](#)
2) [P41151483](#)
3) [P41151484](#)

1) [PZZ80175](#)
2) [P2666103](#)
(Screw Fitting)
[P2666108](#)
(Bayonet Fitting)

[P41733082](#)

(1) Parallel, Semi Finished Liner [P31358343](#) (4.065"OD), and Flanged, Semi Finished Liner [P31358346](#) are also available.

(2) Rope Seal.

(3) Lip Seal.