

**Engine & Equipment  
Application**

# 4.248

4 Cyl, Lip Seal

Bore: 3.9785 in  
101.054 mm

From ESN UA123424L

**APPLICATIONS:**

**LANDINI TRACTORS**  
R8500 (LF22575)

**MF AGRICULTURAL**  
194 (LF22762)  
275 (LF22312/3)  
285 (LF22471)  
290 (LF22790)  
590 (LF22486)

**MF INDUSTRIAL**  
50H

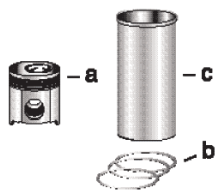

<b>1) Engine O/H Kit</b>	<b>Piston-Liner Kit</b>	<b>Main Bearing Set</b>	<b>Con Rod Bearing Set</b>	<b>Thrust Washer Set</b>
<b>2) Basic Engine Kit</b>	<b>PCK2481</b> Consists of: a) <a href="#">PU5LP0009</a> b) <a href="#">P41158022</a> c) <a href="#">P3135X034</a> (5)	<a href="#">P81558</a> Std. <a href="#">P81558A</a> .010 <a href="#">P81558B</a> .020 <a href="#">P81558C</a> .030	<a href="#">P85042</a> Std. <a href="#">P85042A</a> .010 <a href="#">P85042B</a> .020 <a href="#">P85042C</a> .030	<a href="#">P31137551/61</a>
<b>1) <a href="#">POK461</a></b>		<b>4 Per Engine</b>	<b>Set of 5 Pairs</b>	<b>Set of 2 Pairs</b>
<b>2) <a href="#">PBK461</a></b>				

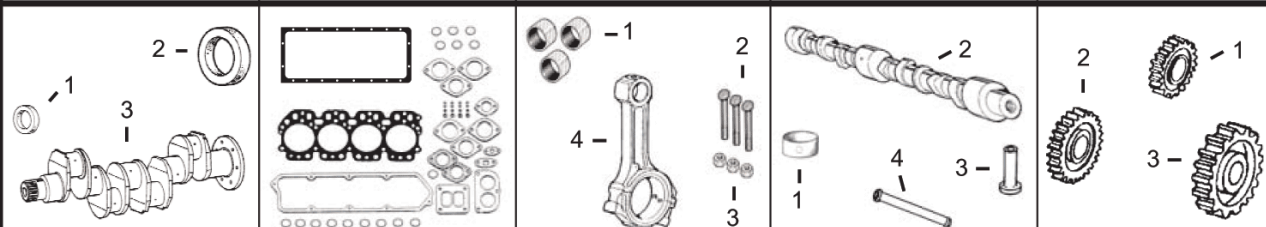

<b>1) Front Seal</b> <b>2) Rear Seal</b> <b>3) Crankshaft Kit</b>	<b>1) Top Gasket Set</b> <b>2) Bottom Gasket</b> <b>3) Valve Cover Gsk</b> 4) Head Gasket 5) Oil Pan Set 6) Timing Cover Gsk	<b>1) Bush, Con Rod</b> <b>2) Bolt, Con Rod</b> <b>3) Nut, Con Rod</b> 4) Con Rod	<b>1) Bushing, Cam</b> 2) Camshaft 3) Tappet 4) Push Rod	1) Crankshaft Gear 2) Camshaft Gear 3) Idler Gear
1) <a href="#">P2418F436</a> 2) <a href="#">P2418F475</a> 3) <a href="#">PZZ90082</a>	1) <a href="#">PU5LT0065</a> 2) <a href="#">PU5LB0045</a> 3) <a href="#">P3681A027</a> 4) <a href="#">P3681E036</a> 5) <a href="#">PU5MK0600</a> 6) <a href="#">P3681P045</a>	1) <a href="#">P31134123</a> x4 2) <a href="#">P32762144</a> x8 3) <a href="#">P33221328</a> x8 4) <a href="#">PZZ90009</a>	1) <a href="#">P31134132</a> x1 2) <a href="#">P31415321</a> (1) <a href="#">P31415374</a> (2) 3) <a href="#">P31434163</a> 4) <a href="#">P31434307</a>	1) <a href="#">P31171681</a> 2) <a href="#">P31171353</a> 3) <a href="#">P41115023</a>

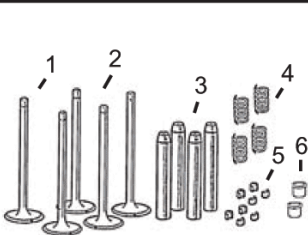

<b>Valve Train Kit</b>	1) Valve, Intake 2) Valve, Exhaust	3) Guide, Valve a) Intake b) Exhaust	4) Spring, Valve a) Inner b) Outer	5) Lock, Valve 6) Seal, Valve
<b><a href="#">PVTK406</a></b>	1) <a href="#">P31431641</a> x4 2) <a href="#">P31431881</a> x4	a) <a href="#">P3343F002</a> x4 b) <a href="#">P3343J002</a> x4	a) <a href="#">P31744131</a> x8 b) <a href="#">P31745121</a> x8	5) <a href="#">P33173108</a> x16 6) <a href="#">P33817117</a> x8

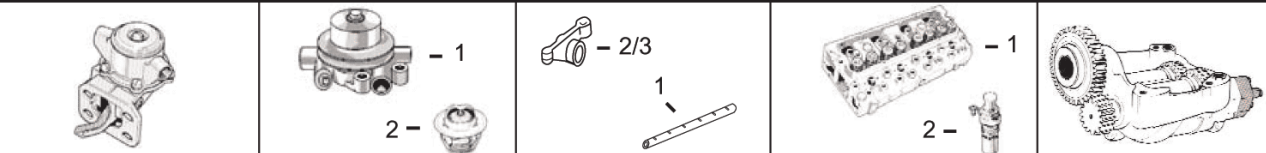
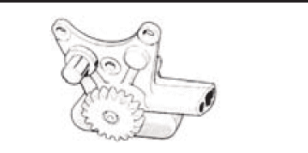

<b>Oil Pump</b>	<b>Lift Pump</b>	1) Water Pump 2) Thermostat	1) Rocker Shaft 2) Rocker Arm LH 3) Rocker Arm RH	1) Cylinder Head (With Valves) 2) Glowplug	<b>Balancer Unit</b>
<a href="#">P4132F041</a> (6)	<a href="#">P2641728</a>	1) <a href="#">P4131A013</a> 2) <a href="#">P2485659</a>	1) <a href="#">PZZ90032</a> 2) <a href="#">P41151483</a> 3) <a href="#">P41151484</a>	1) <a href="#">PZZ80175</a> 2) <a href="#">P2666108</a> (Bayonet Fitting)	<a href="#">P41733082</a> (3) <a href="#">P4111K051</a> (4)

(1) To ESN U108196N.  
(2) From ESN U108197N.  
(3) To ESN U076241N.  
(4) From ESN U076242N.

(5) Flanged, Semi Finished Liner available, [P3135X033](#).  
(6) Used with Balancer Unit [P4111K051](#).