

**Engine & Equipment
Application**

403C-17

(HM)

NATURALLY ASPIRATED

3 Cyl

Bore: 3.3 in
84.00 mm

Stroke: 3.5 in
100.00 mm

Displacement: 101.4 in³
1.662 Liter

Compression Ratio: 22.5:1

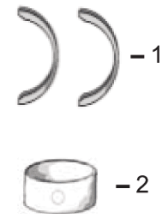

1) Engine O/H Kit

**Piston Kit
Ring Set**

Main Bearing Set

Con Rod Bearing Set

**1) Thrust Washer
2) Crank Bushing**

2) Basic Engine Kit

[P115017491](#) Std.
[P115017491B](#) 0.50

[P198586050](#) Std.
[P198586054](#) .010
[P198586057](#) .020

[P198586080](#) Std.
[P198586084](#) .010
[P198586087](#) .020

1) [P199266200](#) x2

1) [POK318](#) Std.
[POK319](#) 0.50

[P115107970](#) Std.
[P115107970B](#) 0.50

[P198586054](#) .010
[P198586057](#) .020

[P198586084](#) .010
[P198586087](#) .020

2) [P198517222](#) Std.
[P198517226](#) .010
[P198517229](#) .020

2) [PBK318](#) Std.
[PBK319](#) 0.50

[P115107970](#) Std.
[P115107970B](#) 0.50

[P198586054](#) .010
[P198586057](#) .020

[P198586084](#) .010
[P198586087](#) .020

[P198517222](#) Std.
[P198517226](#) .010
[P198517229](#) .020

3 Per Engine

Set of 3 Pairs

Set of 3 Pairs

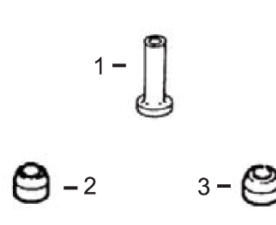
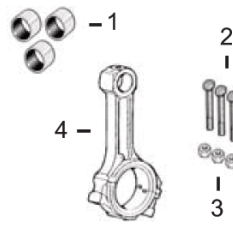
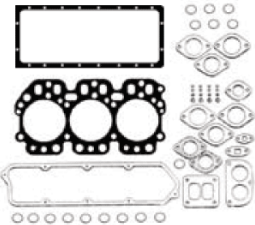
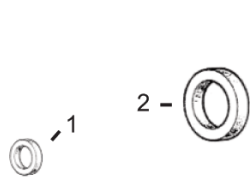

1) Front Seal
2) Rear Seal

1) O/H Gasket Set
2) Cylinder Head Gasket
3) Seal Rocker Box
4) Seal, Cyl Head Cover
5) Oil Pan Gasket

1) Bush, Con Rod
2) Bolt, Con Rod
3) Nut, Con Rod
4) Con Rod

1) Tappet
2) Seal, Intake Valve
3) Seal, Exhaust Valve

1) [P198636160](#)
2) [P050209083](#)

1) [PU5LC0018](#)
2) [P111147501](#)
3) [P120996140](#)
4) [P111996410](#)
5) [P110996910](#)

1) [P198517265](#) x3
2) [P115176140](#) x6
3) [P020109120](#) x6
4) [P115026330](#)

1) [P120116160](#)
2) [P120406070](#) x3
3) [P120406050](#) x3

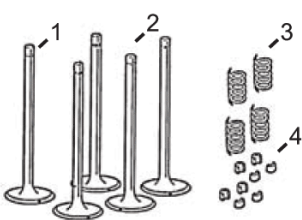

Valve Train Kit

1) Valve, Intake
2) Valve, Exhaust

3) Spring, Valve

4) Lock, Valve

[PVTK309](#)

1) [P120166350](#) x3
2) [P120176360](#) x3

3) [P198216700](#) x6

4) [P120226070](#) x12

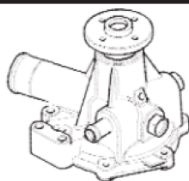

Water Pump



Oil Pump



Thermostat



Repair Sleeve

[P145017951](#)

[PU5MK8266](#)

[P145206182](#)

[84RS](#)