

**Engine & Equipment
Application**

D3.152

DIRECT INJECTION

3 Cyl, Lip Seal

Bore: 3.6020 in
91.491 mm

From ESN UA391045DSL

APPLICATIONS:

LANDINI TRACTORS

5500
5530
5530F
5830
5840

MF AGRICULTURAL

235 (CE22309/10/11)
245
250 (CE31089)

MF INDUSTRIAL

20C
30B

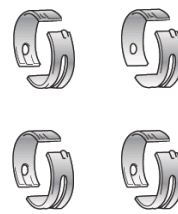
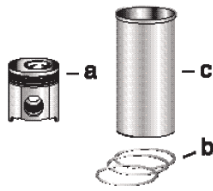

1) Engine O/H Kit

Piston-Liner Kit

Main Bearing Set

Con Rod Bearing Set

Thrust Washer Set

2) Basic Engine Kit

[PU5MK0117](#)

Consists of:

[P68084](#) Std. (4)

[P85036](#) Std.

[P31137211/21](#)

1) POK306

a) [P89214](#)

[P68084A](#) .010

[P85036A](#) .010

b) [P41158065](#)

[P68084B](#) .020

[P85036B](#) .020

2) PBK306

c) [P31358345](#) (3)

[P68084C](#) .030

[P85036C](#) .030

3 Per Engine

Set of 4 Pairs

Set of 3 Pairs

Set of 2 Pairs

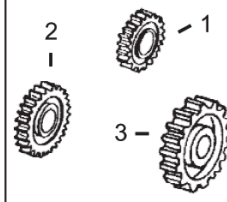
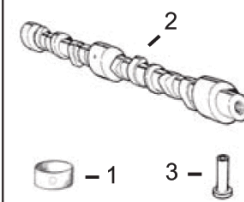
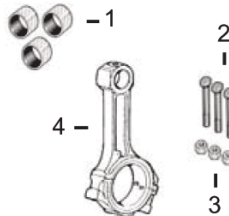
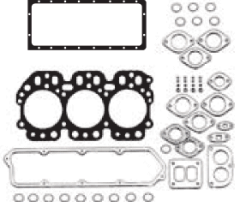
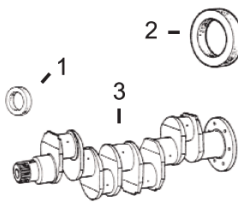

**1) Front Seal
2) Rear Seal**

**1) Top Gasket Set
2) Bottom Gasket**

**1) Bush, Con Rod
2) Bolt, Con Rod
3) Nut, Con Rod**

1) Bushing, Cam
2) Camshaft
3) Tappet

1) Crankshaft Gear
2) Camshaft Gear
3) Idler Gear

3) Crankshaft Kit

3) Head Gasket

4) Con Rod

1) [P2415344](#)
2) [P2418F475](#)
3) [PZZ90078](#)

1) [PU5LT0038](#)
2) [PU5LB0011](#)
3) [P3681E006](#)

1) [P31134151](#) x3
2) [P0095250](#) x6
3) [P33221327](#) x6
4) [PZZ90010](#)

1) [P31134128](#) x1
2) [P31415261](#)
3) [P0860012](#)

1) [P0410132](#)
2) [P0410241](#)
3) [P31164362](#)

Valve Train Kit

1) Valve, Intake
2) Valve, Exhaust

3) Guide, Valve (Intake & Exhaust)

4) Spring, Valve
a) Inner
b) Outer

5) Lock, Valve

[PVTK303](#)

1) [P31431681](#) x3
2) [P31431011](#) x3

3) [P33261723](#) x6

a) Not Used
b) [P0780006](#) x6

5) [P0230001](#) x12

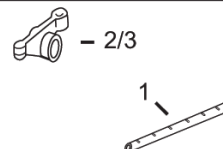
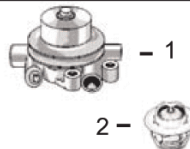
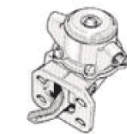
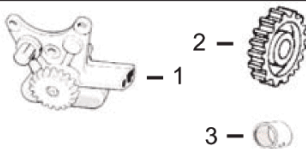
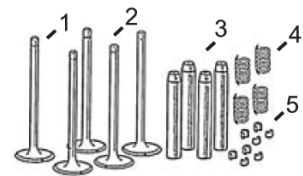

1) Oil Pump
2) Oil Pump Drive Gear
3) Bushing, Drive Gear

Lift Pump

1) Water Pump
a) Without Pulley
b) With Pulley
2) Thermostat

1) Rocker Shaft
2) Rocker Arm LH
3) Rocker Arm RH

1) Cylinder Head (With Valves)
2) Glowplug

1) [P41314078](#)
2) [P41115025](#)
3) [P0050265](#)

[P2641A063](#) (1)
[P2641808](#) (2)

1a) [PU5MW0023](#)
b) [P41312874](#)
2) [P2485666](#)

1) [PZZ90047](#)
2) [P3737A101](#)
3) [P3737A091](#)

1) [PZZ80082](#)
2) [P2666103](#) (Screw Fitting)
[P2666108](#) (Bayonet Fitting)

(1) To Engine No: U635848G (2 Hole).

(2) From Engine No: U635849G (4 Hole).

(3) Semi Finished Liner, [P31358323](#), and Finished Liner in .010", [P31358384](#), are available.

(4) Use Main Bearing Set [PU5MB0014](#) ESN U983574C > For engine kit with these bearings, order [POK306NB](#) or [PBK306NB](#) and nominate the bearings.