

Engine & Equipment  
Application

# D4.203

**DIRECT INJECTION**

4 Cyl, Rope & Lip Seal

(Both Rear Seal Types  
Included in Kit)

Bore: 3.6020 in  
91.491 mm

From ESN 29C1085

**APPLICATIONS:**

**MF AGRICULTURAL**

65  
165  
255  
300 Combine

**MF INDUSTRIAL**

30  
40B  
50  
302  
356  
3165 Tractor Shovel

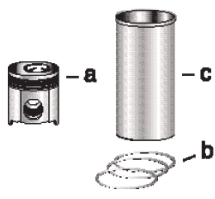

**1) Engine O/H Kit**

**Piston-Liner Kit**

**Main Bearing Set**

**Con Rod Bearing Set**

**Thrust Washer Set**

**2) Basic Engine Kit**

[PU5MK0034](#)

Consists of:

[P68082](#) Std.

[P85035](#) Std.

[P31137211/21](#)

**1) [POK434](#)**

a) [P68332](#)

[P68082A](#) .010

[P85035A](#) .010

**2) [PBK434](#)**

b) [P41158057](#)

[P68082B](#) .020

[P85035B](#) .020

c) [P31358345](#) (3)

[P68082C](#) .030

[P85035C](#) .030

**4 Per Engine**

**Set of 5 Pairs**

**Set of 4 Pairs**

**Set of 2 Pairs**

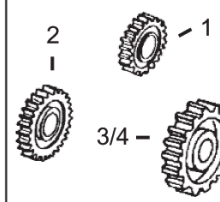
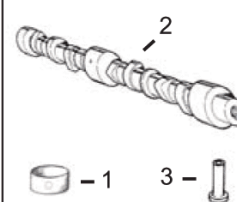
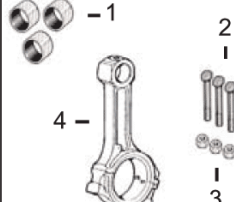
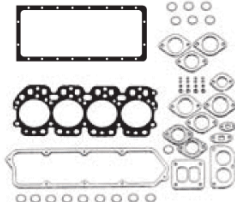
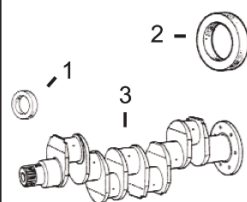

**1) Front Seal**  
**2) Rear Seal**

**1) Top Gasket Set**  
**2) Bottom Gasket**

**1) Bush, Con Rod**  
**2) Bolt, Con Rod**  
**3) Nut, Con Rod**

**1) Bushing, Cam**  
2) Camshaft  
3) Tappet

1) Crankshaft Gear  
2) Camshaft Gear  
3) Idler Gear, Lower  
4) Idler Gear, Upper

3) Crankshaft Kit

3) Head Gasket

4) Con Rod

1) [P2415344](#)  
2) [P36883106](#) x2  
[P2418F475](#)  
3) [PZZ90121](#) (1)  
[PZZ90111](#) (2)

1) [PU5LT0069](#)  
2) [P68036](#)  
3) [P36812138](#)

1) [P31134151](#) x4  
2) [P0095250](#) x8  
3) [P33221327](#) x8  
4) [PZZ90010](#)

1) [P31134119](#) x1  
2) [P31415214](#)  
3) [P0860012](#)

1) [P0410228](#)  
2) [P0410231](#)  
3) [P41115004](#)  
4) [P41115005](#)

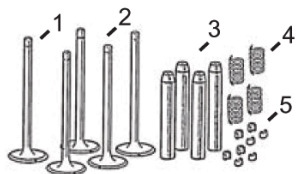

**Valve Train Kit**

1) Valve, Intake  
2) Valve, Exhaust

3) Guide, Valve  
(Intake & Exhaust)

4) Spring, Valve  
a) Inner  
b) Outer

5) Lock, Valve

[PVTK405](#)

1) [P31431281](#) x4  
2) [P31431591](#) x4

3) [P33261723](#) x8

a) [P0780007](#) x8  
b) [P0780006](#) x8

5) [P0230001](#) x16

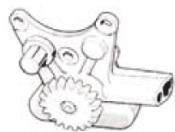

Oil Pump

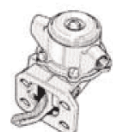

Lift Pump

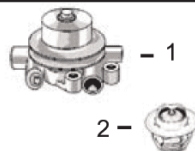

1) Water Pump  
a) Without Pulley  
b) With Pulley  
2) Thermostat

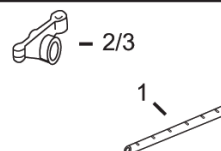

1) Rocker Shaft  
2) Rocker Arm LH  
3) Rocker Arm RH



1) Cylinder Head  
2) Glowplug

[P41314164](#)

[P2641A065](#)

1a) [PU5MW0061](#)  
b) [P41312892](#)  
2) [P2485666](#)

1) [PZZ90139](#)  
2) [P3737A101](#)  
3) [P3737A091](#)

1) [PZZ80078](#)  
2) [P2666103](#)  
(Screw Fitting)  
[P2666108](#)  
(Bayonet Fitting)

(1) Rope Seal.

(2) Lip Seal.

(3) Semi Finished Liner, [P31358323](#), and Finished Liner in .010", [P31358384](#), are available.