

**Engine & Equipment  
Application**

# G4.236

**GASOLINE ENGINE**

**4 Cyl, Lip Seal**

Bore: 3.8770 in  
98.476 mm

From ESN U106655N

**APPLICATIONS:**

**CATERPILLAR**

RT (LE70110)  
T500-1500 (LE70148)  
V80D (LE70089)  
V100-140 (LE70094)

**CLARK EQUIPMENT**

C500-Y60 (LE80173/LE22376)

**EATON CORP**

Forklift (LE80177)

**JACOBSEN MFG CO**

H-15 & F10 Turf Tractor (LE70054)

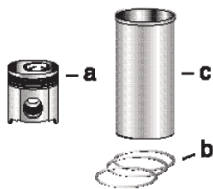
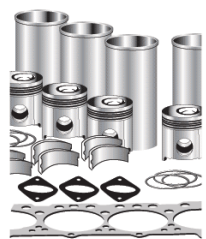

**1) Engine O/H Kit**

**Piston-Liner Kit**

**Main Bearing Set**

**Con Rod Bearing Set**

**Thrust Washer Set**

**2) Basic Engine Kit**

**PCK236G**  
Consists of:  
a) PU5LP0047  
b) P41158142  
c) P3135X032 (4)

P81558 Std.  
P81558A .010  
P81558B .020  
P81558C .030

P85042 Std.  
P85042A .010  
P85042B .020  
P85042C .030

P31137551/61

**1) POK447**

**2) PBK447**

**4 Per Engine**

**Set of 5 Pairs**

**Set of 4 Pairs**

**Set of 2 Pairs**

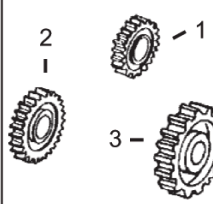
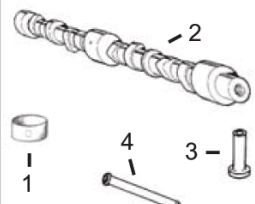
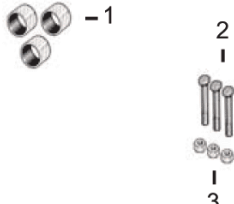
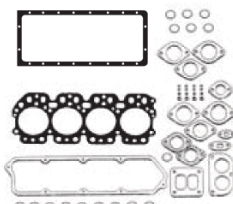
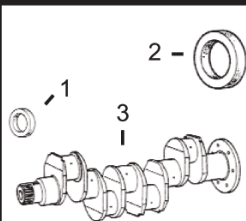

**1) Front Seal  
2) Rear Seal**

**1) Top Gasket Set  
2) Bottom Gasket  
3) Valve Cover Gsk**  
4) Head Gasket  
5) Oil Pan Set  
6) Timing Cover Gsk

**1) Bush, Con Rod  
2) Bolt, Con Rod  
3) Nut, Con Rod**

**1) Bushing, Cam**  
2) Camshaft  
3) Tappet  
4) Pushrod

1) Crankshaft Gear  
2) Camshaft Gear  
3) Idler Gear

**3) Crankshaft Kit**

1) P2418F436  
2) P2418F475  
3) PZZ90082

1) PU5LT0176  
2) PU5LB0046  
3) P3681A027  
4) P3681E036  
5) PU5MK0600  
6) P3681P045 (3)

1) P31134144 x4  
2) P32762144 x8  
3) P33221328 x8

1) P31134132 x1  
2) P31415381  
3) P31434163  
4) P31434307

1) P31171681 (1)  
2) P31171353  
P31171931 (5)  
3) P31171951

**Valve Train Kit**

1) Valve, Intake  
2) Valve, Exhaust

3) Guide, Valve  
a) Intake  
b) Exhaust

4) Spring, Valve  
a) Inner  
b) Outer

5) Lock, Valve  
6) Seal, Valve

**PVTK412**

1) P31431871 x4  
2) P31431701 x4

a) P3343F002 x4  
b) P3343J002 x4

a) P31744131 x8  
b) P31745121 x8

5) P33173108 x16  
6) P33817117 x8

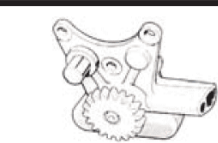
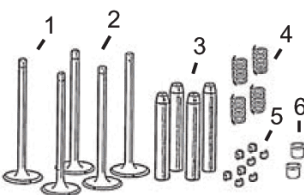

**Oil Pump**

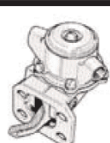

**Lift Pump**

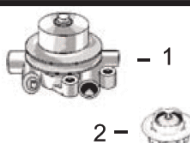

1) Water Pump  
2) Thermostat

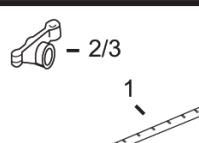

1) Rocker Shaft  
2) Rocker Arm LH  
3) Rocker Arm RH



1) Cylinder Head  
2) Glowplug

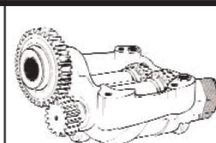

**Balancer Unit**

P41314182

P2641728

1) P4131A013  
PU5MW0105 (7)  
2) P2485666 (6)

1) PZZ90032  
2) P41151483  
3) P41151484

1) N/A  
2) N/A

P41733082 (2)

(1) Do not Use on Build No: LE70089/LE22376/LE80173.

(2) Use on Build No: LE22376/LE80173.

(3) Order with Kit for Build No: LE70089/LE70094.

(4) Flanged, Semi Finished Liner available. P3135X031.

(5) Used on Build Nos: LE70089/LE80173/LE22376.

(6) Used P248513 on Build LE70148 and P2485609 on Build LE80173.

(7) Check with Build List.