

**Engine & Equipment  
Application**

**T6.354.1/  
TC6.354.1**

**TURBOCHARGED**

**6 Cyl, Lip Seal**

Bore: 3.8770 in  
98.476 mm

**APPLICATIONS:**

**MF AGRICULTURAL**

750  
760 (1) (TH21794)  
1105 (TT21724)  
1130 (4)  
1135 (TH22431/TH21722)

**NEW IDEA**

Combine (TH22481)

**WHITE FARM**

2-105 (TH22282)

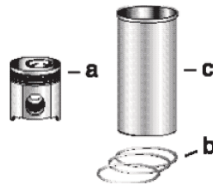

**1) Engine O/H Kit**

**Piston-Liner Kit**

**Main Bearing Set**

**Con Rod Bearing Set**

**Thrust Washer Set**

**2) Basic Engine Kit**

**PCK354**  
Consists of:  
a) [P86726](#)  
b) [P41158031](#)  
c) [P31358394](#) (5)  
**6 Per Engine**

[PU5MB0011](#) Std.  
[PU5MB0011A](#) .010  
[PU5MB0011B](#) .020  
[PU5MB0011C](#) .030  
**Set of 7 Pairs**

[PU5ME0007](#) Std.  
[PU5ME0007A](#) .010  
[PU5ME0007B](#) .020  
[PU5ME0007C](#) .030  
**Set of 6 Pairs**

[P31137551/61](#)  
**Set of 2 Pairs**

**1) [POK661](#)**

**2) [PBK661](#)**

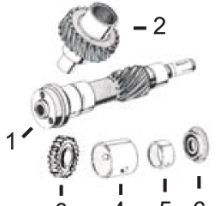
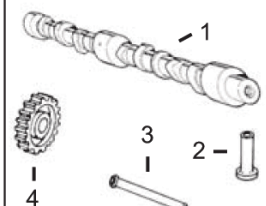
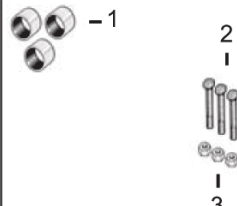
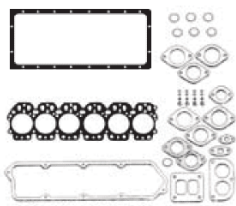
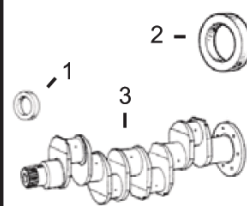

**1) Front Seal**  
**2) Rear Seal**

**1) Top Gasket Set**  
**2) Bottom Gasket**

**1) Bush, Con Rod**  
**2) Bolt, Con Rod**  
**3) Nut, Con Rod**

1) Camshaft  
2) Tappet  
3) Push Rod  
4) Camshaft Gear

1) Aux. Drive Shaft  
2) Gear & Shaft  
3) Gear  
4) Front Bush  
5) Rear Bush  
6) Seal

**3) Crankshaft Kit**

**3) Head Gasket**

1) [P2418F436](#)  
2) [P2418F475](#)  
3) [PZZ90091](#)

1) [PU5LT0026](#)  
2) [PU5LB0056](#)  
3) [P36812547](#)

1) [P31134134](#) x6  
2) [P32762144](#) x12  
3) [P33221328](#) x12

1) N/A  
2) [P31434163](#)  
3) [P31434307](#)  
4) [P31171931](#)

1) [P31173422](#) (3)  
2) [P41115367](#)  
3) [P31171731](#)  
4) [P31134129](#)  
5) [P2511447](#)  
6) [P2418F432](#) (7)

**Valve Train Kit**

1) Valve, Intake  
2) Valve, Exhaust

3) Guide, Valve  
a) Intake  
b) Exhaust

4) Spring, Valve  
a) Inner  
b) Outer

5) Lock, Valve  
6) Seal, Valve

**[PVTK610](#)**

1) [P31431315](#) x6  
2) [P3142A052](#) x6

a) [P3343F002](#) x6  
b) [P3343J002](#) x6

a) [P31744131](#) x12  
b) [P31745121](#) x12

5) [P33173108](#) x24  
6) [P33817117](#) x12

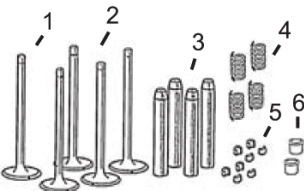

Oil Pump

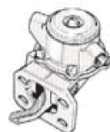

Lift Pump

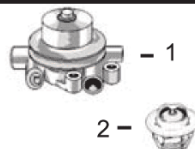

1) Water Pump  
2) Thermostat

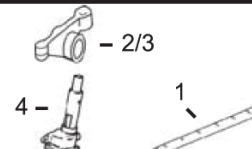

1) Rocker Shaft  
2) Rocker Arm LH  
3) Rocker Arm RH  
4) Relief Valve



1) Cylinder Head  
2) Glowplug

[P41314067](#)

[P2641A064](#)

1) [PU5MW0016](#) (2)  
[PU5MW0123](#) (3)  
2) [P2485666](#) (6)  
[P2485613](#)

1) [PZZ90046](#)  
2) [P41151483](#)  
3) [P41151484](#)  
4) [P41371115](#)

1) N/A  
2) [P2666108](#)  
(Bayonet Fitting)

(1) From ESN UA48970L.

(2) Do Not Use on Build No: TH21794.

(3) Use on Build No: TH22481.

(4) From ESN 354UA3356T.

(5) Parallel, Semi Finished Liner, [P31358324](#), Flanged, Semi Finished Liner, [P31358393](#), and Finished Liner in .010" Oversize, [P31358398](#), are also available.

(6) Check with Build List.

(7) Do not use on Build numbers TH22431 and TH22282.