

Engine & Equipment
Application

T3.152.4

3 Cyl, Lip Seal

Bore: 3.6020 in
91.491 mm

APPLICATIONS:

MF AGRICULTURAL

253 (CN31219)
264 (CN31214)
355 (CN31187)

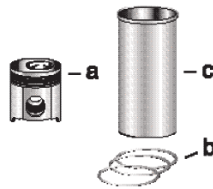

1) Engine O/H Kit

Piston-Liner Kit

Main Bearing Set

Con Rod Bearing Set

Thrust Washer Set

2) Basic Engine Kit

PCK1524
Consists of:

[P68084](#) Std. (2)

[P85036](#) Std.

[P31137211/21](#)

1) [POK311](#)

a) [PU5LP0017](#)

[P68084A](#) .010

[P85036A](#) .010

b) [P41158144](#)

[P68084B](#) .020

[P85036B](#) .020

2) [PBK311](#)

c) [P31358345](#) (1)

[P68084C](#) .030

[P85036C](#) .030

3 Per Engine

Set of 4 Pairs

Set of 3 Pairs

Set of 2 Pairs

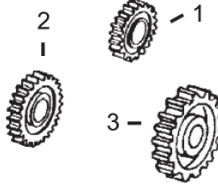
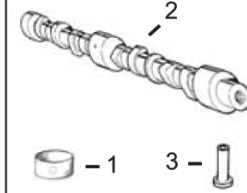
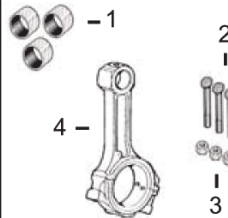
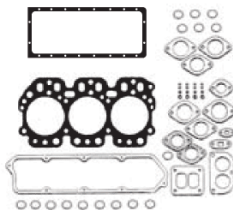
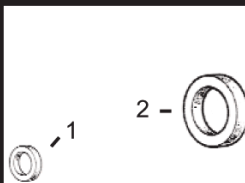

1) Front Seal
2) Rear Seal

1) Top Gasket Set
2) Bottom Gasket

1) Bush, Con Rod
2) Bolt, Con Rod
3) Nut, Con Rod

1) Bushing, Cam
2) Camshaft
3) Tappet

1) Crankshaft Gear
2) Camshaft Gear
3) Idler Gear

3) Head Gasket

4) Con Rod

1) [P2415344](#)
2) [P2418F475](#)

1) [PU5LT0080](#)
2) [PU5LB0011](#)
3) [P3681E006](#)

1) [P31134151](#) x3
2) [P0095250](#) x6
3) [P33221327](#) x6
4) [PZZ90010](#)

1) [P31134128](#)
2) [P31415261](#)
3) [P0860012](#)

1) N/A
2) [P0410241](#)
3) [P31164362](#)

Valve Train Kit

1) Valve, Intake
2) Valve, Exhaust

3) Guide, Valve
a) Intake
b) Exhaust

4) Spring, Valve
a) Inner
b) Outer

5) Lock, Valve

[PVTK306](#)

1) [P31431741](#) x3
2) [P31431731](#) x3

a) [P33261727](#) x3
b) [P33261723](#) x3

a) [P0780007](#) x6
b) [P0780006](#) x6

5) [P0230001](#) x12

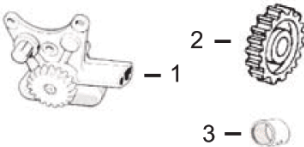
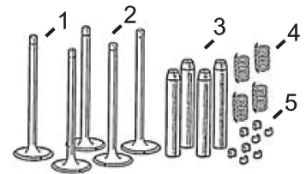

1) Oil Pump
2) Oil Pump Drive Gear
3) Bushing, Drive Gear

Lift Pump

[P2641808](#)

1) [P41314078](#)
2) [P41115025](#)
3) [P0050265](#)

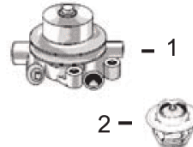

1) Water Pump
a) Without Pulley
b) With Pulley
2) Thermostat

1a) [PU5MW0023](#)
b) [P41312874](#)
2) [P2485666](#)

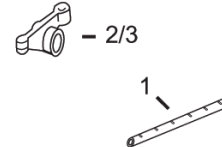

1) Rocker Shaft
2) Rocker Arm LH
3) Rocker Arm RH

1) [PZZ90047](#)
2) [P3737A101](#)
3) [P3737A091](#)

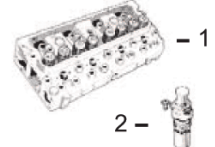

1) Cylinder Head
2) Glowplug

1) N/A
2) [P2666108](#)
(Bayonet Fitting)

(1) Semi Finished Liner, [P31358323](#), and Finished Liner in .010", [P31358384](#), are available.

(2) Use Main Bearing Set, [PU5MB0014](#), from ESN U983574C. For engine kit with these bearings, order [POK311NB](#) or [PBK311NB](#) and nominate the bearings.