



Church Farm-Sheppey Way-Bobbing- Kent
 www.haymac-goodwithwood.co.uk
 01795 424555
 Email office@HAYMAC.org

GALV. BAR A- KENNEL TO RIGHT HAND - RUN DOOR TO END
10ft X 5ft SINGLE POLICE DOG KENNEL
 (2.0m x 1.5m run)
General Arrangement – Not to Scale

All timbers are pressure treated green- Internal lining is untreated OSB3 sheet boarding

All dimensions are external and will be constructed using metric equivalent

PLAN VIEW

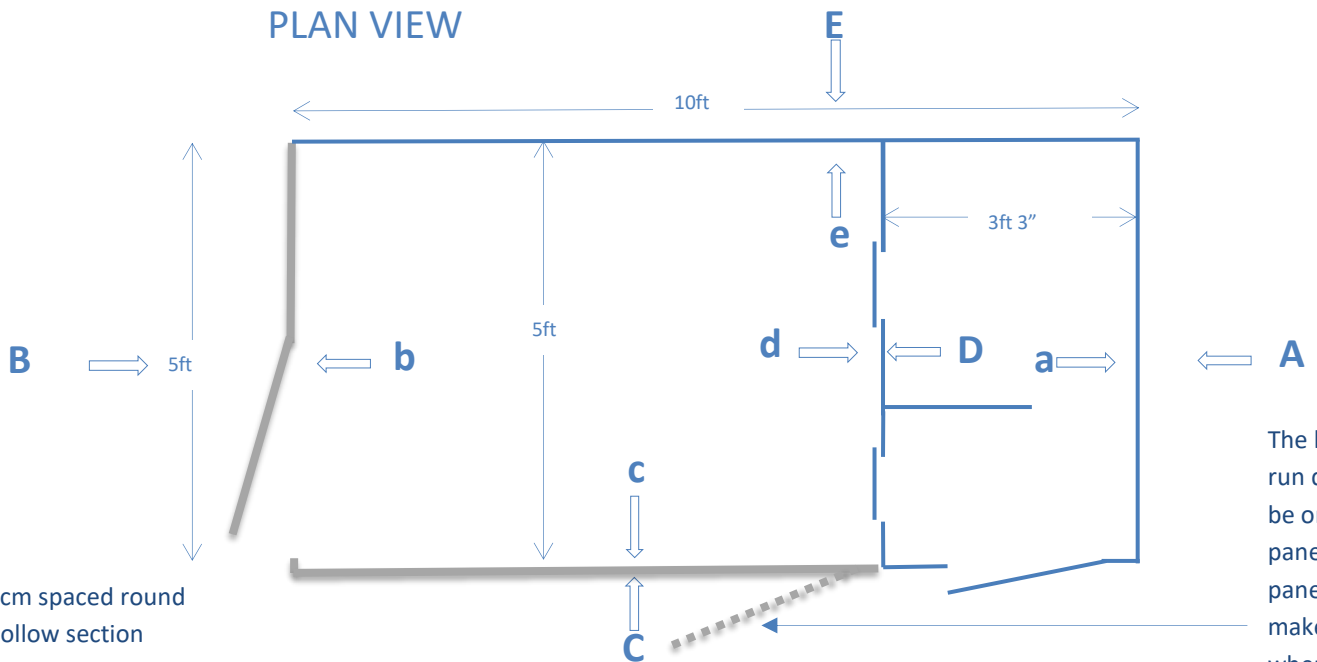

5cm spaced round hollow section galvanized bars made from precision thick 16mm steel tubes which are inserted (top & bottom) into a 25mm x 25mm hot dipped galvanised box section & individually welded complete with an extra strong 8mm centre support bar.

The kennel run door can be on the end panel or front panel - please make clear where you want the kennel run door when placing your order or the kennel will be built to the default option of run door to end.

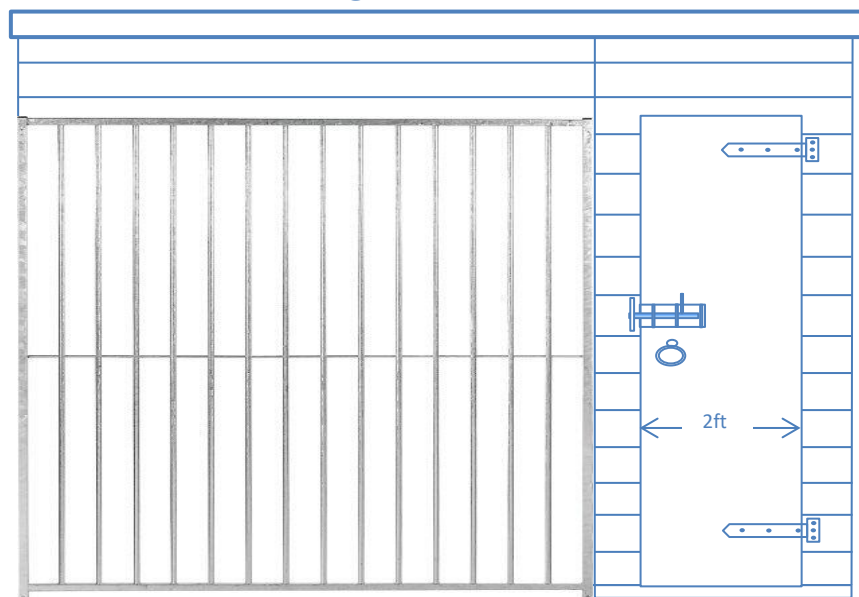

FRONT ELEVATION- C



Church Farm-Sheppey Way-Bobbing- Kent
 www.haymac-goodwithwood.co.uk
 01795 424555
 Email office@HAYMAC.org

GALV. BAR A- KENNEL TO RIGHT HAND - RUN DOOR TO END
10ft X 5ft SINGLE POLICE DOG KENNEL

(2.0m x 1.5m run)

General Arrangement – Not to Scale

FRONT ELEVATION- C

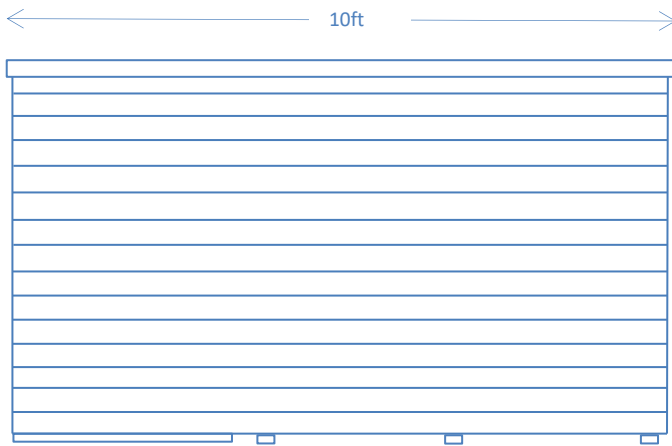

REAR ELEVATION-E

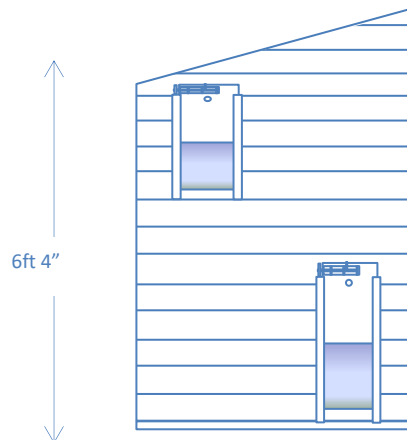

KENNEL POP HOLE –D-from inside run

Lockable sliding pop hole and high level vent

KENNEL END VIEW-A

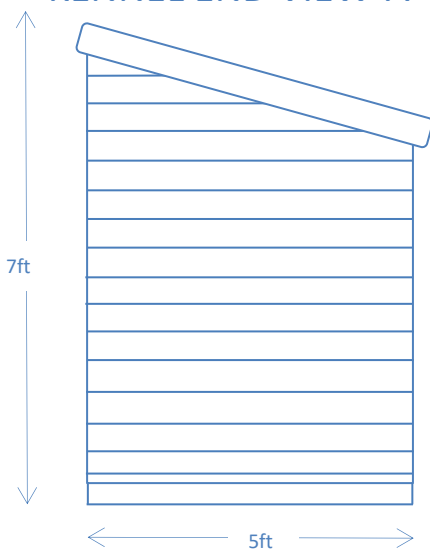

RUN END VIEW-B

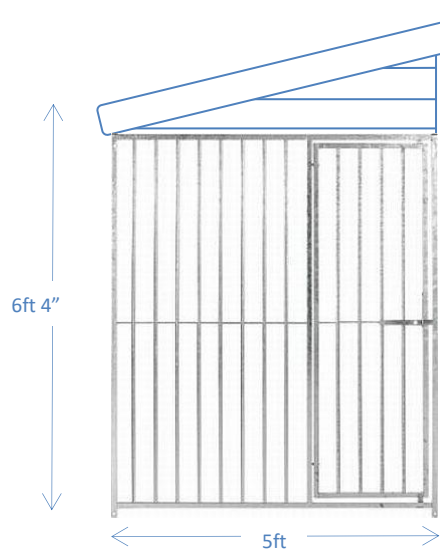

The kennel run door can be on the end panel or front panel - please make clear where you want the kennel run door when placing your order or the kennel will be built to the default option of run door to end.



Church Farm-Sheppey Way-Bobbing- Kent
www.haymac-goodwithwood.co.uk
01795 424555
Email office@HAYMAC.org

GALV. BAR **A-** KENNEL TO RIGHT HAND - RUN DOOR TO END 10ft X 5ft SINGLE POLICE DOG KENNEL (2.0m x 1.5m run) General Arrangement – Not to Scale

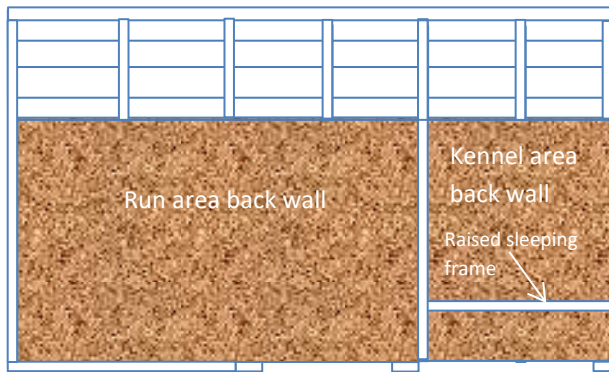

Internal-Rear Panel, view **e**

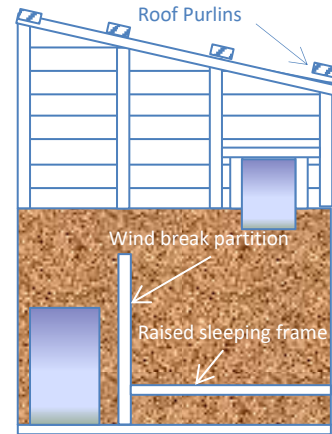

Internal -Pop hole wall, view **D**

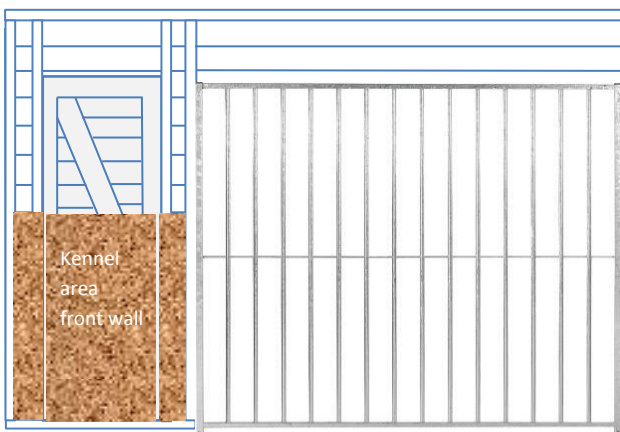

Internal-Front Panel - Inc. kennel, view **C**

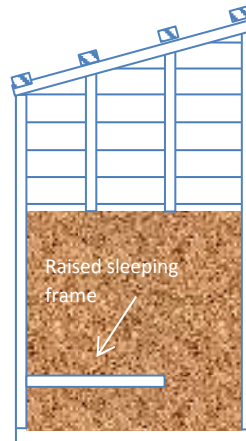

Internal- kennel side wall, view **a**



Internal- Run end wall, view **b**

Detail Showing Internal Cladding

The boards used to protect the framework are sacrificial and easily replaced.



Church Farm-Sheppey Way-Bobbing- Kent
www.haymac-goodwithwood.co.uk
01795 424555
Email office@HAYMAC.org

GALV. BAR **A-** KENNEL TO RIGHT HAND - RUN DOOR TO END
10ft X 5ft SINGLE POLICE DOG KENNEL
(2.0m x 1.5m run)
General Arrangement – Not to Scale

Optional Extras

1. Replacement OSB3 wall boards.
2. Insulation to sleeping kennel with easy wipe clean galvanised sheet wall cladding.
3. Door panel upgrade to included revolving feed & water bowel- no need to enter run to change water or feed. Available in both 1.5m & 2.0m panels complete with a double bowl. Each bowl is made from stainless steel & can hold approx. 3 litres of water.



4. Upgrade timber sliding pop-hole to full metal galvanized pop-hole- advisable if your dog likes to chew the kennel framework around the pop-hole. Operated from outside the kennel by a pulley system.

