



Church Farm-Sheppey Way-Bobbing- Kent
 www.haymac-goodwithwood.co.uk
 01795 424555
 Email office@HAYMAC.org

STANDARD A- KENNEL TO RIGHT HAND - RUN DOOR TO END

10ft X 5ft SINGLE POLICE DOG KENNEL

General Arrangement – Not to Scale

All timbers are pressure treated green- Internal lining is untreated OSB3 sheet boarding

All dimensions are external and will be constructed using metric equivalent

PLAN VIEW

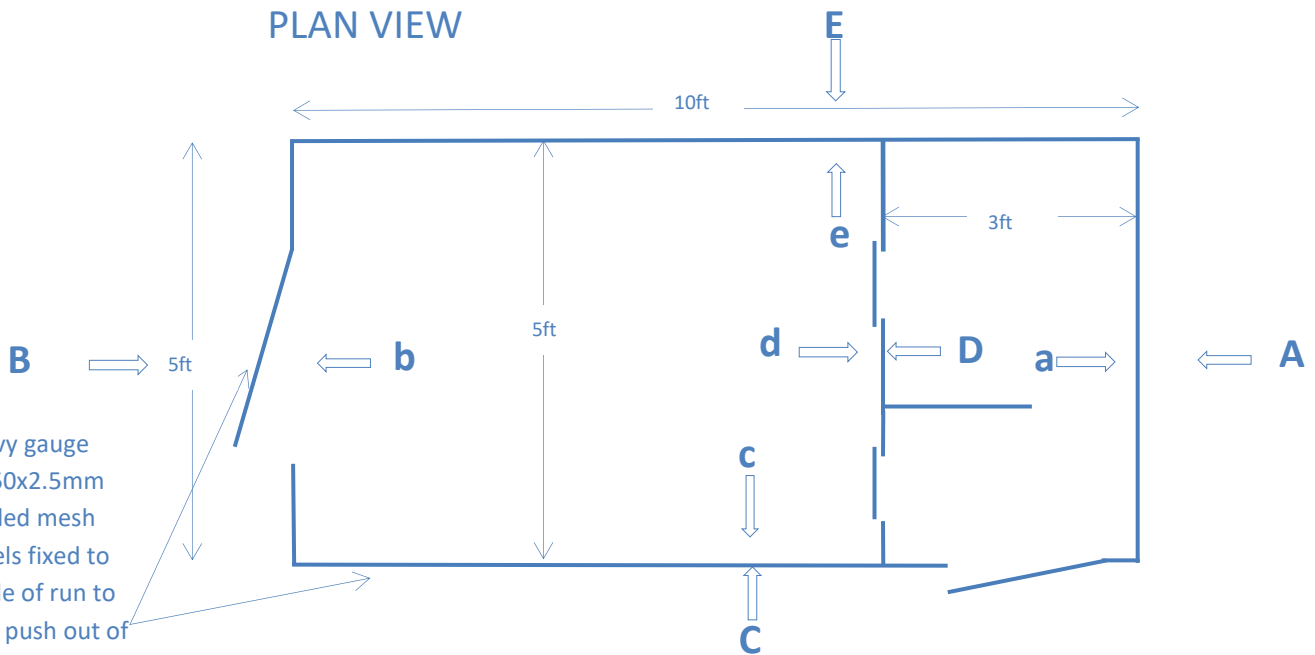

Heavy gauge 50x50x2.5mm welded mesh panels fixed to inside of run to stop push out of mesh screen by larger dogs

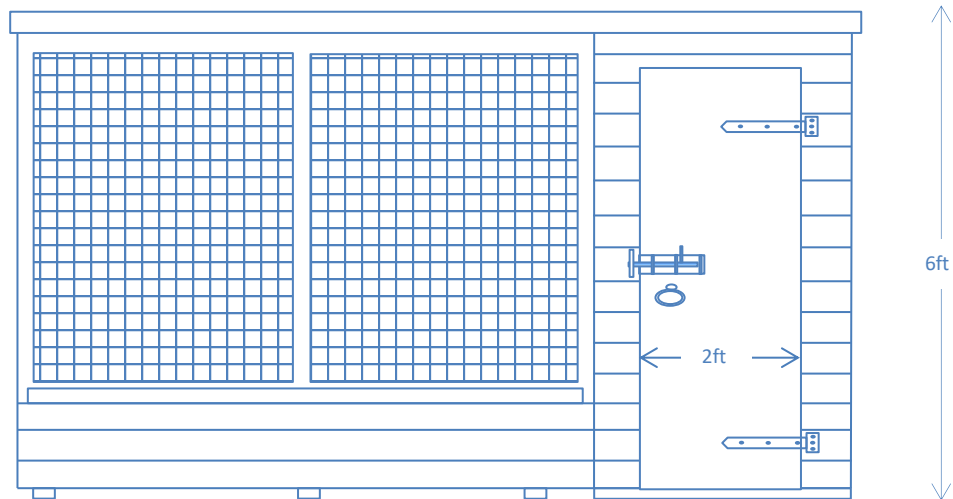

FRONT ELEVATION- C

Internal walls to sleeping quarters clad to 4ft high to stop chewing & scratching damage to frame- sacrificial boarding- optional hygienic easy clean plastic cladding at additional cost



Church Farm-Sheppey Way-Bobbing- Kent
www.haymac-goodwithwood.co.uk
01795 424555
Email office@HAYMAC.org

STANDARD **A-** KENNEL TO RIGHT HAND - RUN DOOR TO END

10ft X 5ft SINGLE POLICE DOG KENNEL

General Arrangement – Not to Scale

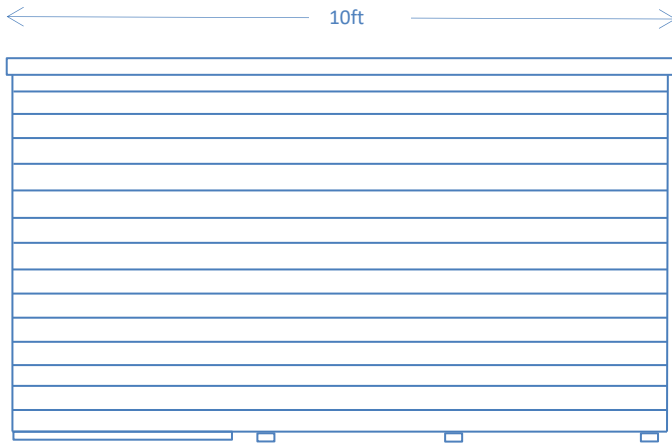

REAR ELEVATION-E

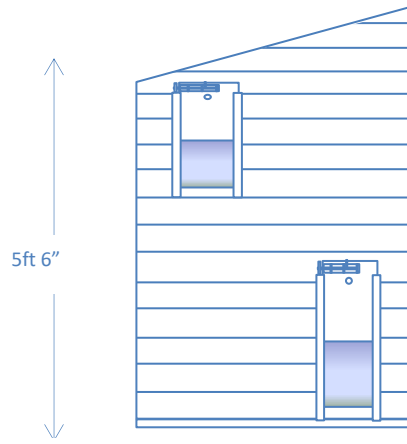

KENNEL POP HOLE –D-from inside run
Lockable sliding pop hole and high level vent

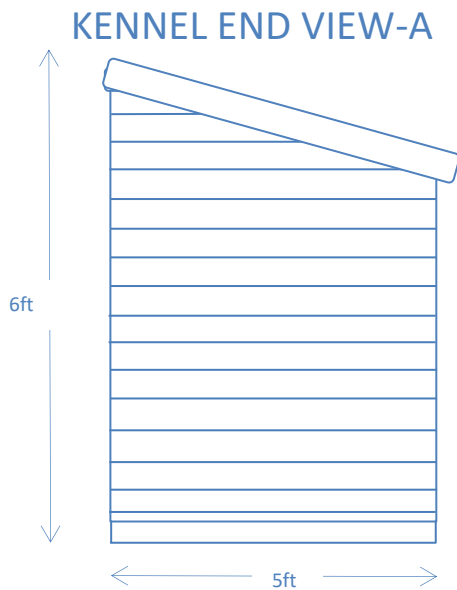

KENNEL END VIEW-A

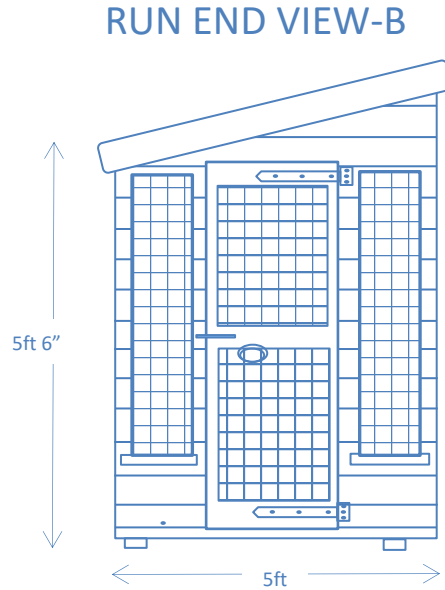

RUN END VIEW-B



Church Farm-Sheppey Way-Bobbing- Kent
www.haymac-goodwithwood.co.uk
01795 424555
Email office@HAYMAC.org

STANDARD **A-** KENNEL TO RIGHT HAND - RUN DOOR TO END

10ft X 5ft SINGLE POLICE DOG KENNEL

General Arrangement – Not to Scale

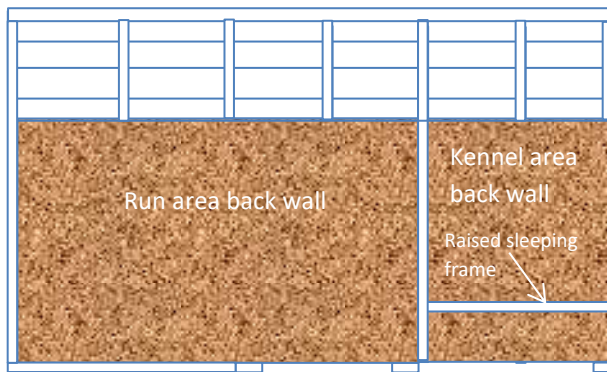

Internal- Rear Panel, view **e**

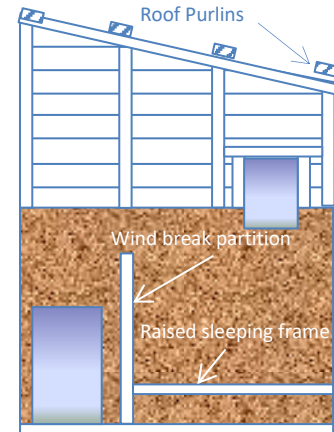

Internal -Pop hole wall, view **D**

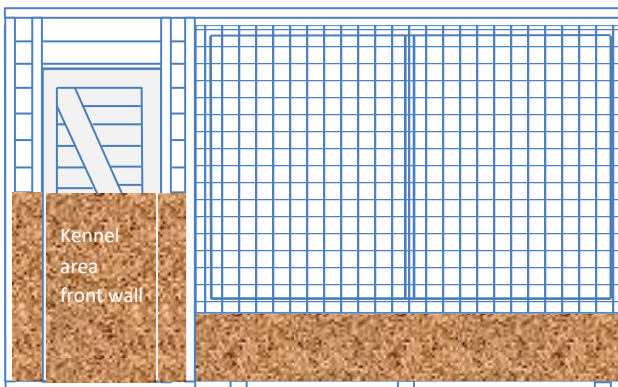

Internal-Front Panel - Inc. kennel, view **C**

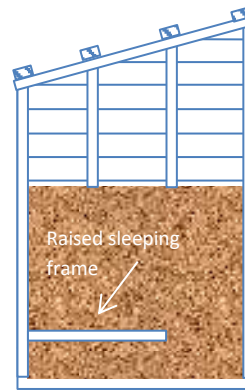

Internal- kennel side wall, view **a**

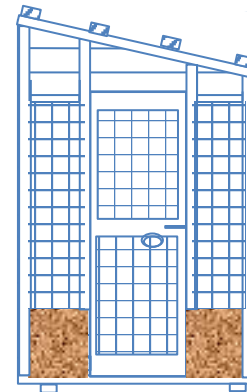

Internal- Run side wall, view **b**

Detail Showing Internal Cladding

The boards used to protect the framework are sacrificial and easily replaced. Optional insulation to sleeping kennel area available at extra cost.