



# STANDARD **D** KENNEL TO RIGHT HAND – RUN DOOR TO FRONT

## 10ft X 5ft SINGLE POLICE DOG KENNEL

### General Arrangement – Not to Scale

Church Farm-Sheppey Way-Bobbing- Kent  
www.haymac-goodwithwood.co.uk  
01795 424555  
Email office@HAYMAC.org

All timbers are pressure treated green- Internal lining is untreated OSB3 sheet boarding

All dimensions are external and will be constructed using metric equivalent

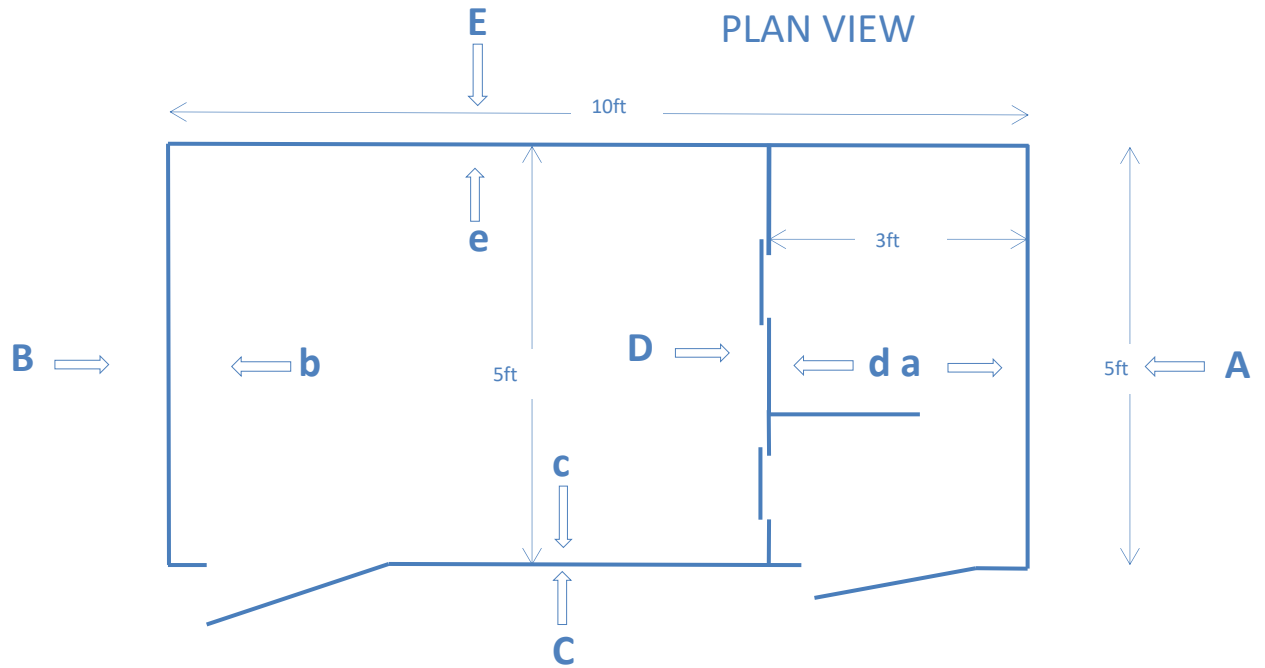

Heavy gauge 50x50x2.5mm welded mesh panels fixed to inside of run to stop push out of mesh screen by larger dogs

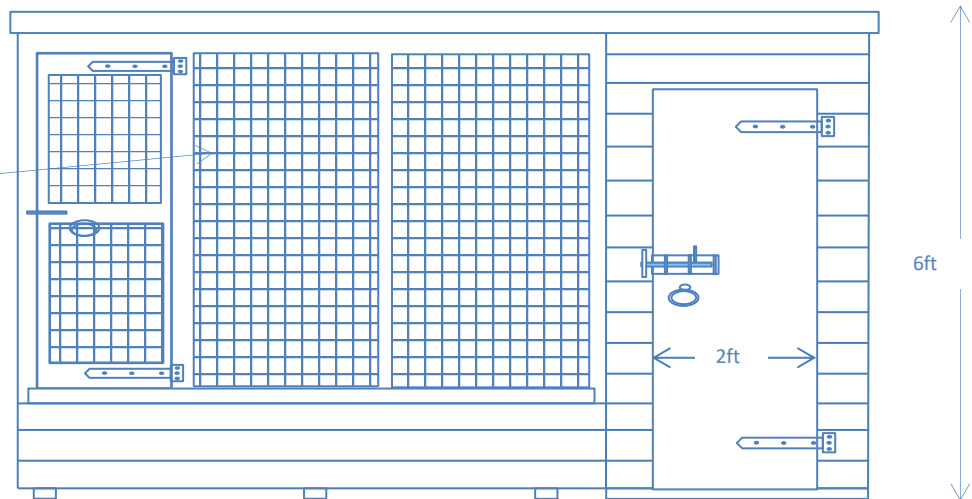

### FRONT ELEVATION- C

Internal walls to sleeping quarters clad to 4ft high to stop chewing & scratching damage to frame- sacrificial boarding- optional hygienic easy clean plastic cladding at additional cost



# STANDARD **D** KENNEL TO RIGHT HAND – RUN DOOR TO FRONT

## 10ft X 5ft SINGLE POLICE DOG KENNEL

### General Arrangement – Not to Scale

Church Farm-Sheppey Way-Bobbing- Kent  
www.haymac-goodwithwood.co.uk  
01795 424555  
Email office@HAYMAC.org

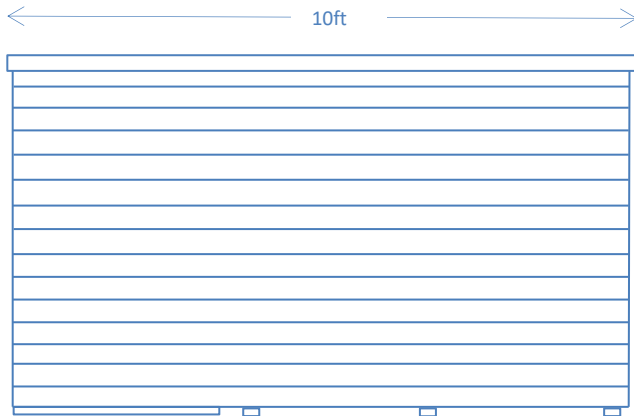

REAR ELEVATION-E

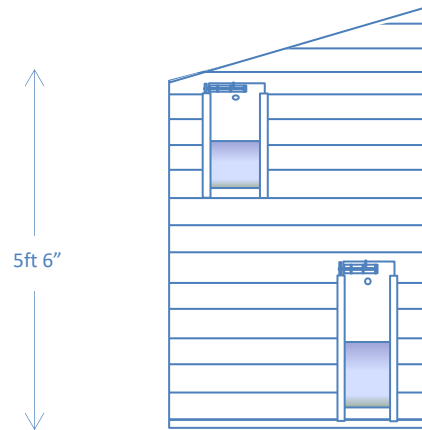

KENNEL POP HOLE –D-from inside run

Lockable sliding pop hole and high level vent

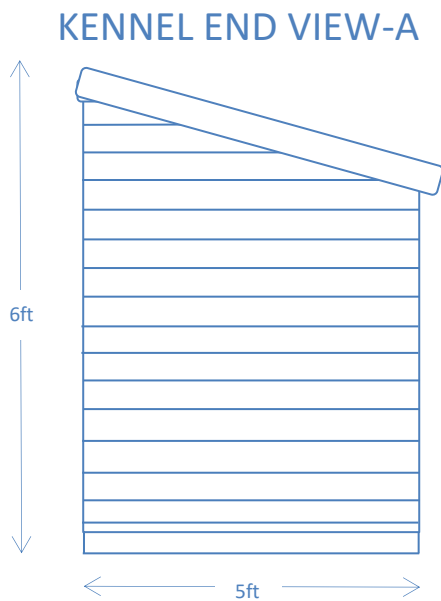

KENNEL END VIEW-A

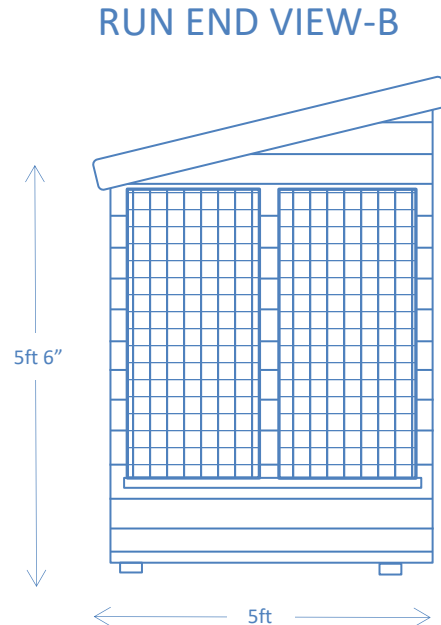

RUN END VIEW-B



# STANDARD **D** KENNEL TO RIGHT HAND – RUN DOOR TO FRONT

## 10ft X 5ft SINGLE POLICE DOG KENNEL

### General Arrangement – Not to Scale

Church Farm-Sheppey Way-Bobbing- Kent  
www.haymac-goodwithwood.co.uk  
01795 424555  
Email office@HAYMAC.org

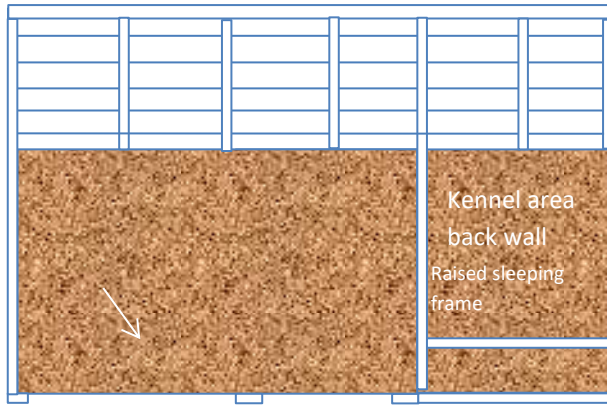

Internal- Rear Panel, view **e**

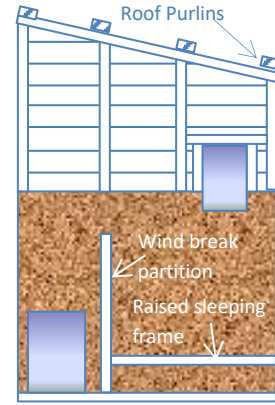

Internal -Pop hole wall, view **d**

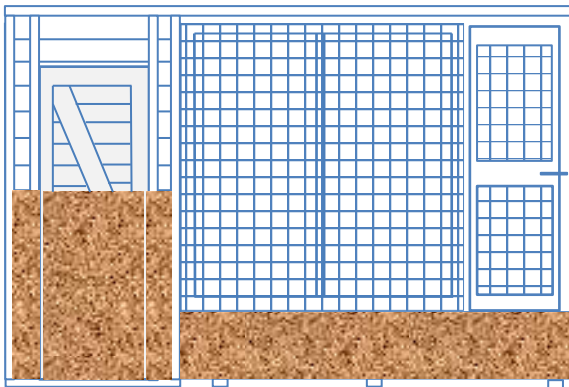

Internal-Front Panel - Inc. kennel, view **c**

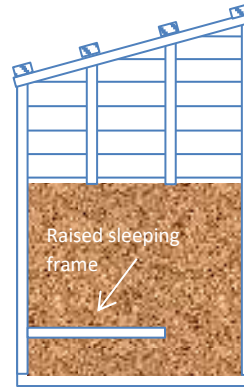

Internal- kennel side wall,  
view **a**

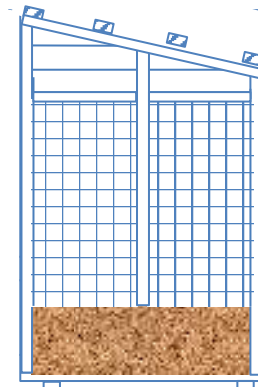

Internal- Run side wall,  
view **b**

## Detail Showing Internal Cladding

The boards used to protect the framework are sacrificial and easily replaced. Optional insulation to sleeping kennel area available at extra cost.