

## H4D2PRV2

### 1080P H.264 IP Weather-Proof IR Dome Camera

The H4D2PRV2 1080P IP True Day/Night IR Dome camera is Honeywell's newest affordable, fully-featured IP camera that pair perfectly with a 4/8/16-channel Performance Series IP 1080P NVR. This IR-illuminated, IP66-rated camera is an ideal, flexible solution for your surveillance needs.

#### Flexible Surveillance Solution

- IR LEDs facilitate recording in dimly lit or nighttime scenes
- Waterproof (IP66) and impact resistant (IK10) camera housing is perfect for outdoor installations
- Camera configurations help to improve image quality and compress image size, and to detect and respond to alarm events
- 2.8 - 12mm vari-focal lens covers a wide range of field of view requirements

#### Easy to Use

- The Quick wizard and PoE support plug-and-play make setup fast and easy
- Physical installation within minutes with the help of simple camera design and comprehensive and easy-to-understand quick installation guides
- Simple remote configuration and firmware updating through the Honeywell Viewer web client and the Honeywell configuration tool

#### Dynamic, Accessible Monitoring

- Monitor from anywhere using the mobile apps for both Apple and Android devices (smart phones, tablet computers, and laptops)
- Network monitoring includes the transmission of some alarm information through SNMP
- Password-protected access to the camera's video and network setup

#### Privacy Masking

- Conceal up to 4 areas of a scene from viewing and recording

#### Event Monitoring Features

- Configurable motion detection and camera tamper detection settings, including configurable alarm alerts, such as automatic emails (with attached video or snapshot image)

#### Market Opportunities

This fully-featured IR True Day/Night IP camera is the perfect complement to your Honeywell (HEN Series) or third party Embedded IP NVR. Together, they are an excellent option for many security applications

### Camera Features

- 25/30 fps @ 1080p (1920 x 1080) H.264 and MJPEG dual stream
- True Day/Night capability with IR-cut filter
- Weatherproof IP66-rated, vandal-resistant IK10-rated housing
- 2.8 - 12mm vari-focal lens
- Supports Internet Explorer®, Chrome™ and Firefox®
- Supports HDCS V5.0 central management software and HonView Touch mobile app
- Smart infrared (IR) technology for even distribution of IR
- Depending on scene reflectance, IR LEDs provide up to 20m illumination
- Compact design for fast, easy installation
- Built-in Power over Ethernet (PoE) and 12V DC
- DWDR, 3DNR, AWB, AGC, BLC
- Digital watermark for tamper-proof video
- IPv6, SNMP, ONVIF Profile S



# H4D2PRV2

## 1080P H.264 IP Weather-Proof IR Dome Camera

### SPECIFICATIONS

<b>Model</b>	HBD2PRV2
<b>Operational</b>	
Video Standard	PAL / NTSC
Scanning System	Progressive
Image Sensor	1/2.8" 2 Megapixel progressive scan Sony Exmor CMOS
Effective Pixels	1920 (H) x 1080 (V)
Minimum Illumination	0.01Lux @ F1.4 (Color), 0 Lux @ F1.4 (IR LEDs on)
IR LEDs	850nm, 2 High Power LEDs
IR Illumination Distance	20m depending on scene reflectance, Smart IR
S/N Ratio	More than 50dB
Gain Control	Auto / Manual
Electronic Shutter Speed	Auto/Manual, 1/3(4) - 1/10000s
Lens Type	2.8 - 12mm VFMI, F1.4
Horizontal Angle of View	98.1° - 29.9°
White Balance	Auto / Manual
Day/Night	Auto (ICR) / Color / B&W
Backlight Compensation	BLC / HLC / DWDR
Exposure Mode	Manual / Low noise / Low motion blur / Auto Ranges from 1/3 to 1/10000
Noise Reduction	3D DNR
Video Flip	Support mirror function and flip function.
Snapshot	Max 1f/s snapshot. File extension name is JPEG
Privacy Mask	Supports 4 privacy mask zones (maximum)
Video Setup	Support parameter setup such as bright, contrast
Video Information	Channel title, time title, motion detect, privacy mask
Motion Detection	396 (18 x 22) detection zones; sensitivity level ranges from 0 to 100; area threshold ranges from 0 to 100. Activation event: video storage, image snapshot, log, email function and etc.
<b>Electrical</b>	
Power Supply	12 V DC, or PoE IEEE 802.3af
Power Consumption	4.5 W maximum
<b>Mechanical</b>	
Dimensions	Φ122mm×89mm
Weight	0.5kg
Connectors	Ethernet port RJ-45 10/100Base-T; 2.1 mm Female barrel socket for 12 V DC
<b>Environmental</b>	
Operational Temperature	-30°C to +60°C
Relative Humidity	Less than or equal to 95%
Weatherproof Rating	IP66
Impact Rating	IK10

# H4D2PRV2

## 1080P H.264 IP Weather-Proof IR Dome Camera

### SPECIFICATIONS

Model	HBD2PRV2
<b>IP Specification</b>	
Video Compression	H.264 / MJPEG
Primary Stream Resolution	1080p (1920x1080) / 1.3M (1280x960) / 720P (1280x720) / D1 (704x576 / 704x480) / CIF (352x288 / 352x240)
Frame Rate	<b>Primary Stream:</b> 1080p / 1.3M / 720p / D1 @ 1~25/30 fps <b>Secondary Stream:</b> D1 / CIF @ 1~25/30 fps
Video Streaming	Dual streaming: H.264 / MJPEG
Video Bit Rate	H.264: 1280 ~ 8192Kbps @ 1080p
Security	Up to 20 users, multiple user access levels with password protection
Supported Protocols	IPv4/IPv6, HTTP, HTTPS, SSL, TCP/IP, UDP, UPnP, ICMP, IGMP, SNMP, RTSP, RTP, SMTP, NTP, DHCP, DNS, PPPOE, DDNS, FTP, IP Filter, QoS, Bonjour
Smart Phone / Tablet Compatibility	IOS, Android
Standards	ONVIF Profile S
<b>Network</b>	
Remote Operation	Monitor; system setup; log information; maintenance upgrades.
<b>Regulatory</b>	
Emissions	FCC Part 15B, CE (EN 55022)
Immunity	EN 50130-4
Safety	EN 60950-1 North America UL listed to UL/CSA 60950-1

Windows and Internet Explorer are registered trademarks of Microsoft Corporation in the United States and other countries.  
Note: Honeywell reserves the right, without notification, to make changes in product design or specifications.

# H4D2PRV2

www.asia.security.honeywell.com

## 1080P H.264 IP Weather-Proof IR Dome Camera

### DIMENSIONS

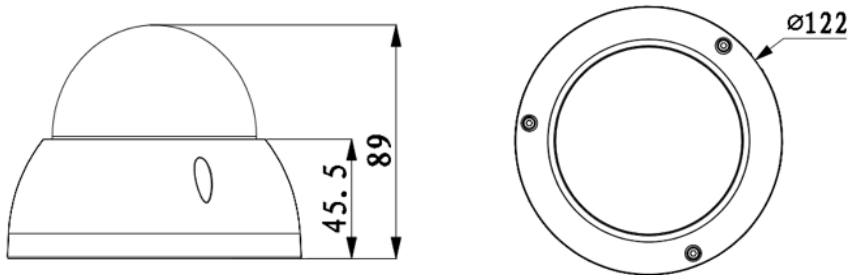

Unit: mm

### ORDERING

H4D2PRV2	1080P IP Weather-proof IR Dome Camera, 1/2.8" 2Megapixel progressive scan Exmor CMOS, 2.8 - 12mm, 20m IR distance, IP66, IK10, H.264, TDN, DWDR, 3DNR, AWB, AGC, BLC, ONVIF Profile S, PoE, 12VDC
----------	---

For more information:

Security Australia Sales Hotline  
Security China Sales Hotline  
Security Hong Kong  
Security India  
Security Indonesia

Tel: 1300 234 234  
Tel: 400-8800-330  
Tel: (852) 2405 2323  
Tel: (91) 124 497 5000  
Tel: (62 21) 536 52322

Security Korea  
Security Singapore  
Security Taiwan  
Security Thailand  
Security Vietnam

Tel: (82) 2 799 6114  
Tel: (65) 6355 2828  
Tel: (886) 2 2245 1000  
Tel: (66) 2 693 3099  
Tel: (84) 8 3910 6012/13

www.asia.security.honeywell.com  
security.ap@honeywell.com

Honeywell Security Group  
Honeywell International Inc.  
www.security.honeywell.com

May 2015  
© 2015 Honeywell International Inc.

# Honeywell