

Before setting the vehicle in motion, the driver of the tractor should give horn signal, then start moving being careful to see that there is nobody in front of the tractor.

While towing the vehicle:

- sharp jerks, turns and abrupt stops are not permitted;
- between the crew members of the tractor and the towed vehicle there should be reliable communication /visual or radio/;
- from time to time check condition and fastening of the towing rope;
- do not stop at invisible curves, in mountain passes, bridges and intersections;
- when going across ice and bridges, all hatch doors should be opened, only drivers should be in the towed vehicle and the tractor.

REQUIREMENTS DURING TECHNICAL SERVICING AND REPAIR

All activities connected with technical servicing and repair should be carried out with efficient tools and instruments while the engine or battery is cut off. Also take into account the possibility of the presence of hot coolant and oil in the pipe conduits and assemblies of the vehicle.

Mounting and dismantling of pipes of high pressure should be done with air cylinders cut off after reducing air pressure in the pipes.

Do not use open fire while inspecting storage battery, fuel tanks and combat equipment.

When doing work in the engine compartment, the hatches over it, in addition to securing them by lever /4/ /Fig. 1/, should be secured by bars/5/.

Setting up and taking off lamp KGM 27-200 from its socket should be done holding only by its ceramic piece. Protective canvas to be taken off lamp only after its setting up in its socket.

- loosen two bolts on the hatch block, than fix searchlight bracket and take off searchlight.

Setting up the searchlight is done in a reverse order.

8. Possible troubles of the vision device and their troubleshooting

Possible troubles of the vision device, their reasons and their troubleshooting are given in table 1.

Table 1

Inefficiency	Reason	Remedy
1. In the device ocular there is no greenish background.	1. Feeding cable short-circuited or broken.	Remove inefficiency.
	2. Electronic-optical converter /PEO/ does not work.	Replace vision device.
2. The greenish back-ground appears on the screen, but there is no picture, the searchlight control lamp shines /OU-3GKM/.	1. Searchlight bulb burned.	Replace bulb.
	2. Searchlight feeding cable short-circuited or broken.	Remove inefficiency.
3. In the field of view there appear dark spots impairing vision.	Electronic-optical converter /PEO/ damaged. Reason-lighting with spot light source.	Replace the vision device.

Initial length of trench is 8-10 m. By gradual backing of the vehicle into initial position, as the depth increases, make it 10-14 m long.

After digging out, for instance, a half of the trench depth, the vehicle ought to be driven out of it and, after order has been given by the vehicle commander, it should continue moving in reverse gear, take position on the other side of the trench and carry on digging it until required depth is reached, in accordance with the following diagram.

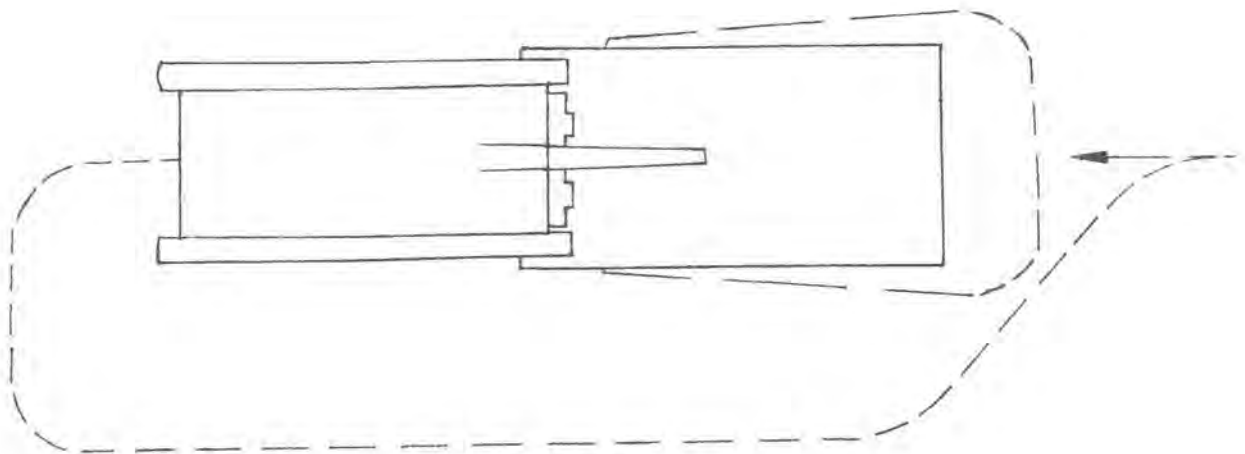

The diagram of displacement of the vehicle while digging the trench

In cohesive grounds, which do not give way under caterpillars, the trench should be dug 5-5.5 m wide on the surface and gradually narrowing as depth increases e.g. for the width of the vehicle.

The trench should be dug up with shuttle movement displacing the vehicle to right and left along the diagonal in small angle in relation to longitudinal axis of the trench.

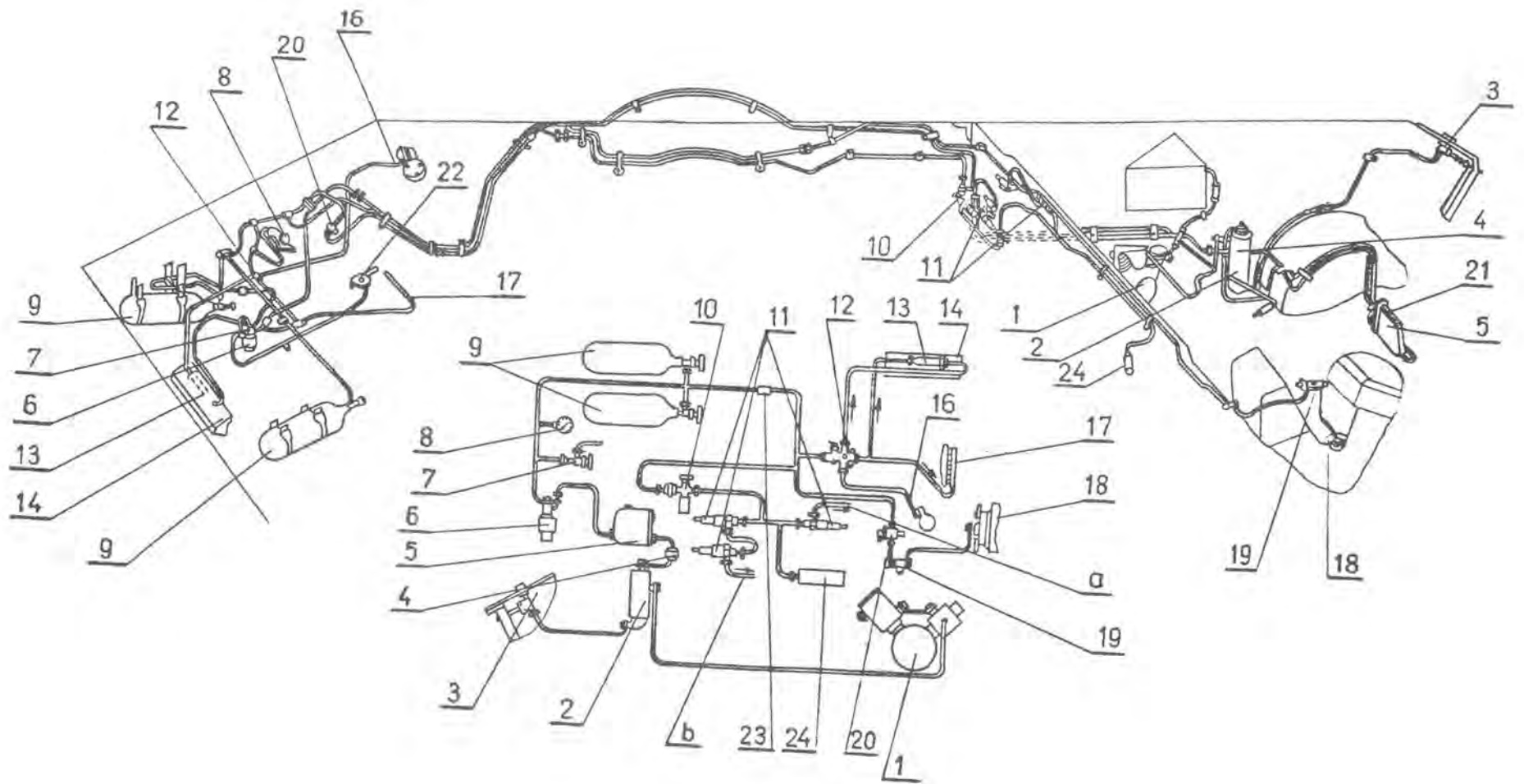

Fig.7