

Plans & Planting for the Jubilee Rose Garden

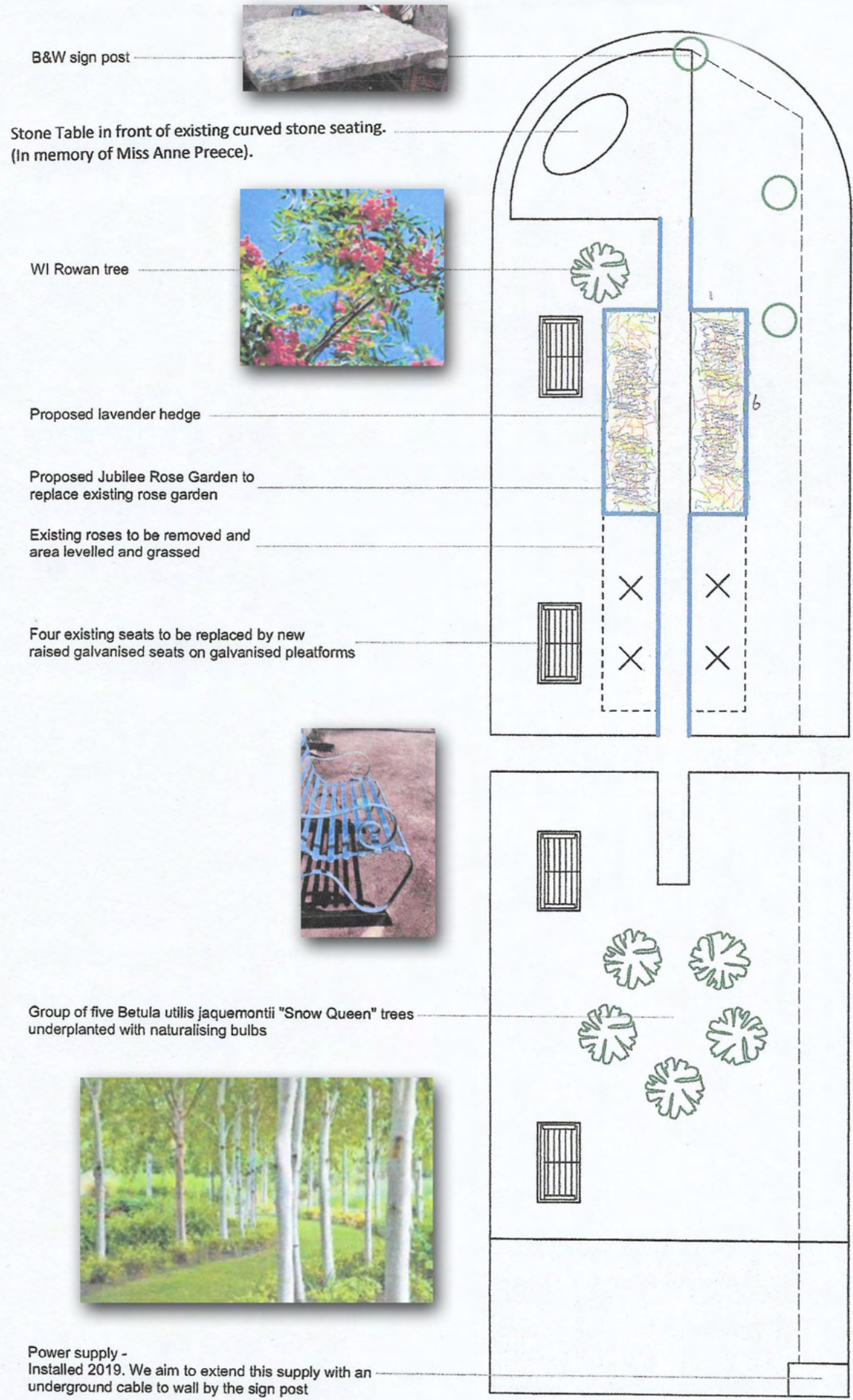

B&W sign post

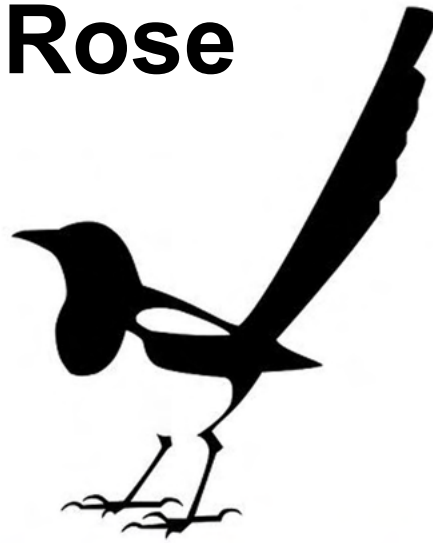

Stone Table in front of existing curved stone seating. (In memory of Miss Anne Preece).

WI Rowan tree



Proposed lavender hedge

Proposed Jubilee Rose Garden to replace existing rose garden

Existing roses to be removed and area levelled and grassed

Four existing seats to be replaced by new raised galvanised seats on galvanised platforms



Group of five Betula utilis jaquemontii "Snow Queen" trees underplanted with naturalising bulbs



Power supply - Installed 2019. We aim to extend this supply with an underground cable to wall by the sign post

